

U.S. Department of  
Homeland Security

United States  
Coast Guard



Commander  
United States Coast Guard  
Thirteenth District

915 Second Avenue, Rm 3510  
Seattle, WA 98174-1067  
Staff Symbol: dpw  
Phone: (206) 220-7282

19 December 2018

## **PUBLIC NOTICE (06-18)**

The Commander, Thirteenth Coast Guard District has received an application from BNSF Railway Co. (BNSF), requesting approval of location and plans for a new bridge over a navigable waterway of the United States. At this time the Coast Guard has not completed the draft environmental document and a separate public notice (PN) and Federal Register notice will be published announcing the document and its availability at a future date. Therefore, this PN is soliciting for comments exclusively related to navigation. The public is highly encouraged to carefully review this notice, attached plans, and diagrams and then provide comments with regard to the proposed bridge's ability to meet the reasonable needs of navigation.

**WATERWAY AND LOCATION:** Lake Pend Oreille, Bonner County, ID, at latitude, longitude 48°15'25.33"N; 116°31'40.09"W.

**CHARACTER OF WORK:** BNSF proposes to construct a new bridge approximately 50 feet west of, and parallel to, the existing bridge. The new bridge will be a fixed, 49-span, 4,874-foot-long. Made of precast, pre-stressed concrete I-girders, a cast-in-place concrete deck, and pre-cast concrete caps over 48 in-water piers. The existing bridge will remain in service.

### **MINIMUM NAVIGATIONAL CLEARANCE: (above ordinary high water, OHW)**

	<b><u>* Existing</u></b>	<b><u>Proposed</u></b>
Horizontal:	Main Channel 84.0 ft	Main Channel 93.0 ft.
Vertical:	14.1 ft at lighted channels and 16.1 to 16.4 ft N & S sides of main navigation channel	14.6 ft at lighted channels and 14.7 to 15.5 ft N & S sides of main navigation channel

\* See attachment drawings for explanation \*

**SOLICITATION OF COMMENTS:** Mariners and maritime stakeholders are requested to express their views, in writing, on the proposed bridge and its possible impact on navigation, if any, giving sufficient detail to establish a clear understanding of their reasons for support of, or opposition to, the proposed work.

Comments will be received for the record at the office of: Commander (dpw), Thirteenth Coast Guard District, 915 2<sup>nd</sup> Ave, Rm 3510, Seattle, WA or via email at [D13-PF-D13BRIDGES@uscg.mil](mailto:D13-PF-D13BRIDGES@uscg.mil). Comments should be mailed to arrive on or before 17 January 2019.

//s//

STEVEN M. FISCHER  
Chief, Bridge Program  
Thirteenth Coast Guard District  
By direction of the District Commander

"This is a web-searchable copy and is not the official, signed version; however, other than the signature being omitted, it is a duplicate of the official version."

U.S. Department of  
Homeland Security

United States  
Coast Guard



Commander  
United States Coast Guard  
Thirteenth District

915 Second Avenue  
Seattle, WA 98174-1067  
Staff Symbol: dpw  
Phone: (206) 220-7282

16591  
19 December 2018

## AVAILABILITY OF PUBLIC NOTICE (06-18)

All interested parties are notified that the Commander, Thirteenth Coast Guard District has received an application from BNSF Railway Co. (BNSF), requesting approval of location and plans for a new bridge over a navigable waterway of the United States. At this time the Coast Guard has not completed the draft environmental document and a separate public notice (PN) and Federal Register notice will be published announcing the document and its availability at a future date. Therefore, this PN is soliciting for comments exclusively related to navigation. The public is highly encouraged to carefully review this notice, attached plans, and diagrams and then provide comments with regard to the proposed bridge's ability to meet the reasonable needs of navigation.

**WATERWAY AND LOCATION:** Lake Pend Oreille, Bonner County, ID, at latitude, longitude 48°15'25.33"N; 116°31'40.09"W.

**CHARACTER OF WORK:** BNSF proposes to construct a new bridge approximately 50 feet west of, and parallel to, the existing bridge. The new bridge will be a fixed, 49-span, 4,874-foot-long. Made of precast, pre-stressed concrete I-girders, a cast-in-place concrete deck, and pre-cast concrete caps over 48 in-water piers. The existing bridge will remain in service.

## **MINIMUM NAVIGATIONAL CLEARANCE: (above ordinary high water, OHW)**

	<u>Existing</u>	<u>Proposed</u>
Horizontal:	Main Channel 84.0ft	Main Channel 93.0ft.
Vertical:	14.1ft at lighted channel & 16.1 to 16.4ft. N. & S. sides of main navigation Channel.	14.6ft. at lighted channel & 14.7 to 15.5 5ft. N. & S. sides of main navigation channel.

\* See public notice for explanation \*

## **FOR MORE INFORMATION INCLUDING INSTRUCTIONS ON PROVIDING COMMENTS:**

The complete public notice (numbered 05-18) including: a brief summary of project impacts, a map of the location, and plans for the proposed bridge can be viewed and printed from website

<https://www.navcen.uscg.gov/D13BN> or by calling, emailing, or mailing a request to the Coast Guard Bridge Administrator, Mr. Steven Fischer. Telephone (206)220-7282 or by mail at Commander (dpw), Thirteenth Coast Guard District, 910 2<sup>nd</sup> Avenue, Suite 3510, Seattle, WA or via email at [D13-PF-D13BRIDGES@uscg.mil](mailto:D13-PF-D13BRIDGES@uscg.mil). Comments should be mailed to arrive on or before 17 January 2019.

Comments received will be made part of the case record.

**All federal, state and local agencies and public representatives are requested to submit an e-mail address(es) to the project manager to obtain this public notice and announcements of future public notices from this office.**

\*\*\*\*\*

PUBLIC NOTICE(s)

19 December 2018; The Coast Guard District has received two applications from BNSF Railway Co. (BNSF) requesting approval of location and plans for two new bridges over navigable waterways of the United States, near Sandpoint, Idaho, one across Lake Pend Oreille at 48-15-01.0N 116-32-14.9W and the other across Sand Creek at 48-16-19.5N 116-32-38.9W. At this time, the Coast Guard has published two public notices (PN), 05-18 and 06-18, soliciting comments from mariners exclusively related to navigation issues in relation to these two proposed bridges. The public is highly encouraged to carefully review these notices, attached plans, and diagrams and then provide comments with regard to the proposed bridges' abilities to meet the reasonable needs of navigation. When the Coast Guard has completed the draft environmental document related to these proposed bridges, they will publish a subsequent PN and a Federal Register notice announcing the document and its availability. PN 05-18 and 06-18 solicit comment and are available at <https://www.navcen.uscg.gov/D13BN>. Comments are requested by 17 Jan 2019, and should be addressed to the Bridge Administrator, Steve Fischer, at (206) 220-7282 or email [D13-pf-D13Bridges@uscg.mil](mailto:D13-pf-D13Bridges@uscg.mil).

\*\*\*\*\*

## IDAHO – LAKE PEND ORIELLE AND SAND CREEK – BNSF Bridge Notice(s)

The Commander, Thirteenth Coast Guard District has received two applications from BNSF Railway Co. (BNSF), requesting approval of location and plans for two new bridge over navigable waterway of the United States. One across Lake Pend Orielle ID, at [48°15'01.0"N 116°32'14.9"W](#) and the other across Sand Creek ID. at [48°16'19.5"N 116°32'38.9"W](#). At this time the Coast Guard has not completed the draft environmental document and a separate public notice (PN) and Federal Register notice will be published announcing the document and its availability at a future date. Therefore, these PNs (05-18 and 06-18) are soliciting for comments exclusively related to navigation for the two bridges. The public is highly encouraged to carefully review these notices, attached plans, and diagrams and then provide comments with regard to the proposed bridge's ability to meet the reasonable needs of navigation.

Public Notice 05-18 and 06-18 solicits comment and is available at <https://www.navcen.uscg.gov/D13BN> Question or comments can be addressed to the Bridge Administrator, Mr. Steve Fischer at (206) 220-7282, or [steven.m.fischer3@uscg.mil](mailto:steven.m.fischer3@uscg.mil).

Chart: XXXXX

# Proposed Project Location

## BNSF Bridge 3.9





# Concept – Bridge 3.9

## Lake Pend Oreille (North End)



Current Bridge

New Proposed Bridge

← NORTH



# Current vertical navigation clearances for BNSF 3.9 Bridge over Lake Pend Oreille



## Bridge South End



Note: #s represent feet of vertical navigation clearances above Ordinary High Water (OHW) or Summer Pool (2062.5')



# Proposed vertical navigation clearances for second BNSF 3.9 Bridge over Lake Pend Oreille



## Bridge South End

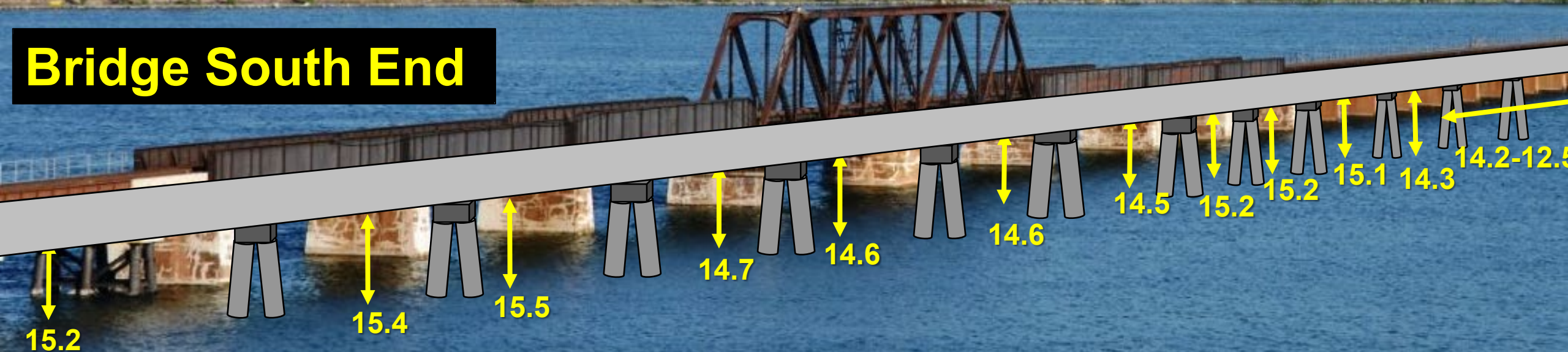

Note #1: #s represent feet of vertical navigation clearances above Ordinary High Water (OHW) or Summer Pool (2062.5')

Note #2: New bridge piles in the navigation spans shown align with existing piles. Other new sections have approximately

USCG001298

SHORELINE

SANDPOINT, ID

PLAN - 1

LAKE PEND OREILLE  
(STATE OF IDAHO)

EX BRIDGE 3.9

PLAN - 2

PROP BRIDGE 3.9

PLAN - 3

BNSF ROW

PLAN - 4

LAKE PEND OREILLE  
(STATE OF IDAHO)

HWY 95 CAUSEWAY

SPokane, WA

PLAN - 5

SHORELINE

PLAN - 6



250' 0 250' 500'

APPROX. GRAPHIC SCALE: 1" = 500'

BASED ON: HANSON PROFESSIONAL SERVICES, INC. PRELIMINARY PLANS.  
ELEVATIONS ARE RELATIVE TO NAVD88. CONCEPTUAL PLANS UTILIZED TO OBTAIN COAST GUARD BRIDGE PERMIT

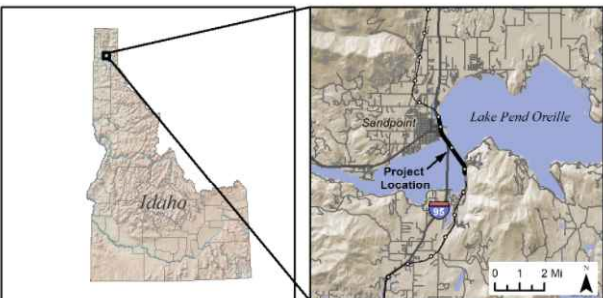

## VICINITY / LOCATION MAP

**PROJECT:** BNSF / SANDPOINT JUNCTION CONNECTOR BRIDGE 3.9  
**OWNER:** BNSF RAILWAY COMPANY  
**CONSULTANT:** JACOBS ENGINEERING GROUP  
**LOCATION:** BNSF BRIDGE 3.9 MONTANA DIVISION, KOOTENAI RIVER SUB, LINE SEGMENT 45, MP 3.9  
**MILE POINT OF BRIDGE LOCATION FROM MOUTH:** 2.7  
**WATERWAY:** LAKE PEND OREILLE  
**CITY:** SANDPOINT **COUNTY:** BONNER **STATE:** IDAHO  
**DATE:** 12/11/2018

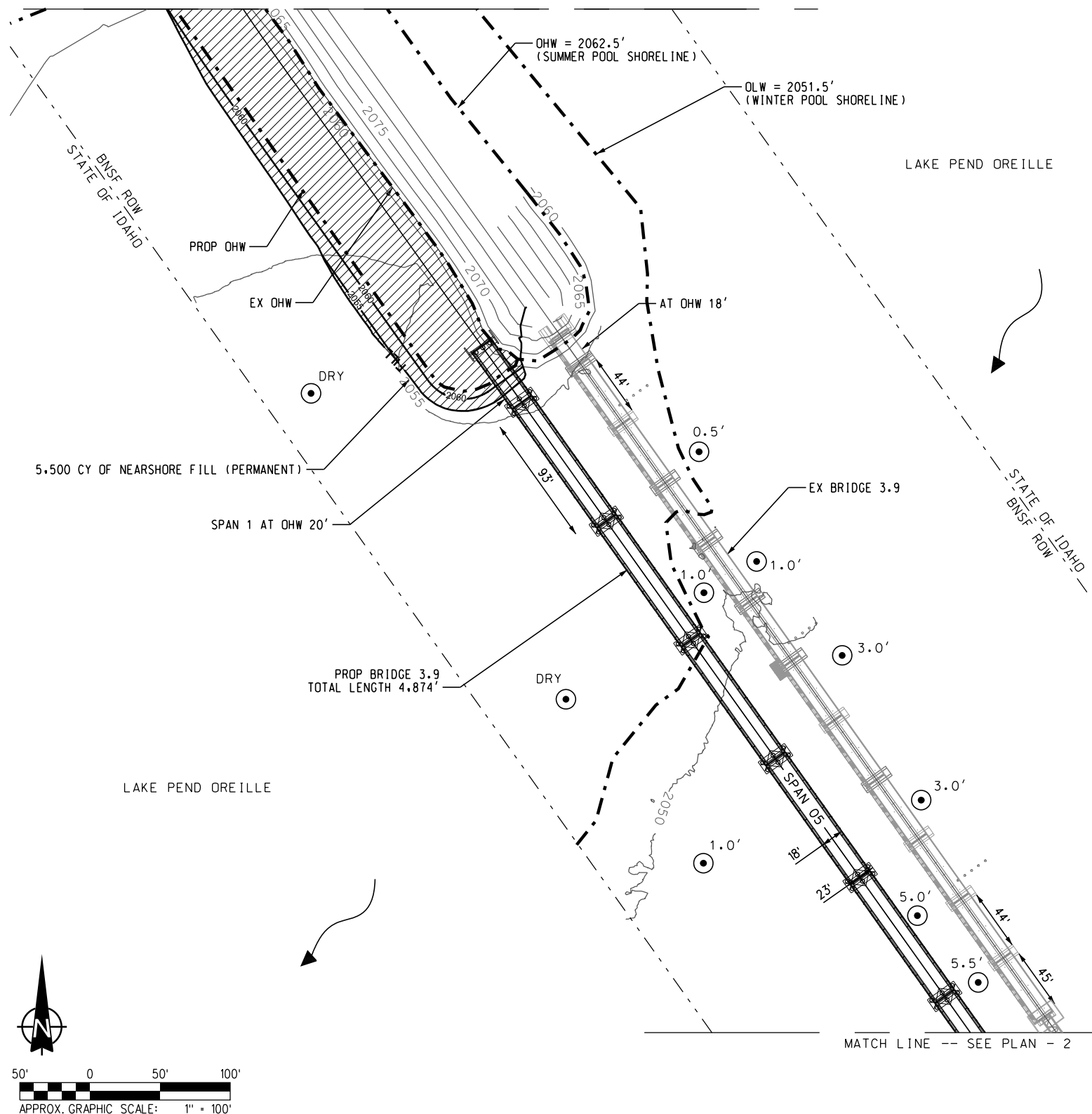

BASED ON: HANSON PROFESSIONAL SERVICES, INC. PRELIMINARY PLANS. ELEVATIONS ARE RELATIVE TO NAVD88. CONCEPTUAL PLANS UTILIZED TO OBTAIN U.S. COAST GUARD BRIDGE PERMIT

#### LEGEND

- BNSF RIGHT-OF-WAY (ROW)
- SHORELINE (SUMMER AND WINTER POOL)
- STRUCTURE (ROADS, DOCKS, EXISTING BRIDGE)
- 1.0' WATER DEPTH AT WINTER POOL

#### EXISTING CONDITIONS / PROPOSED WORK

**PROJECT:** BNSF / SANDPOINT JUNCTION CONNECTOR BRIDGE 3.9  
**OWNER:** BNSF RAILWAY COMPANY  
**CONSULTANT:** JACOBS ENGINEERING GROUP  
**LOCATION:** BNSF BRIDGE 3.9 MONTANA DIVISION, KOOTENAI RIVER SUB, LINE SEGMENT 45, MP 3.9  
**MILE POINT OF BRIDGE LOCATION FROM MOUTH:** 2.7  
**WATERWAY:** LAKE PEND OREILLE  
**CITY:** SANDPOINT **COUNTY:** BONNER **STATE:** IDAHO  
**DATE:** 12/11/2018

USCG001300  
MATCH LINE -- SEE PLAN - 1

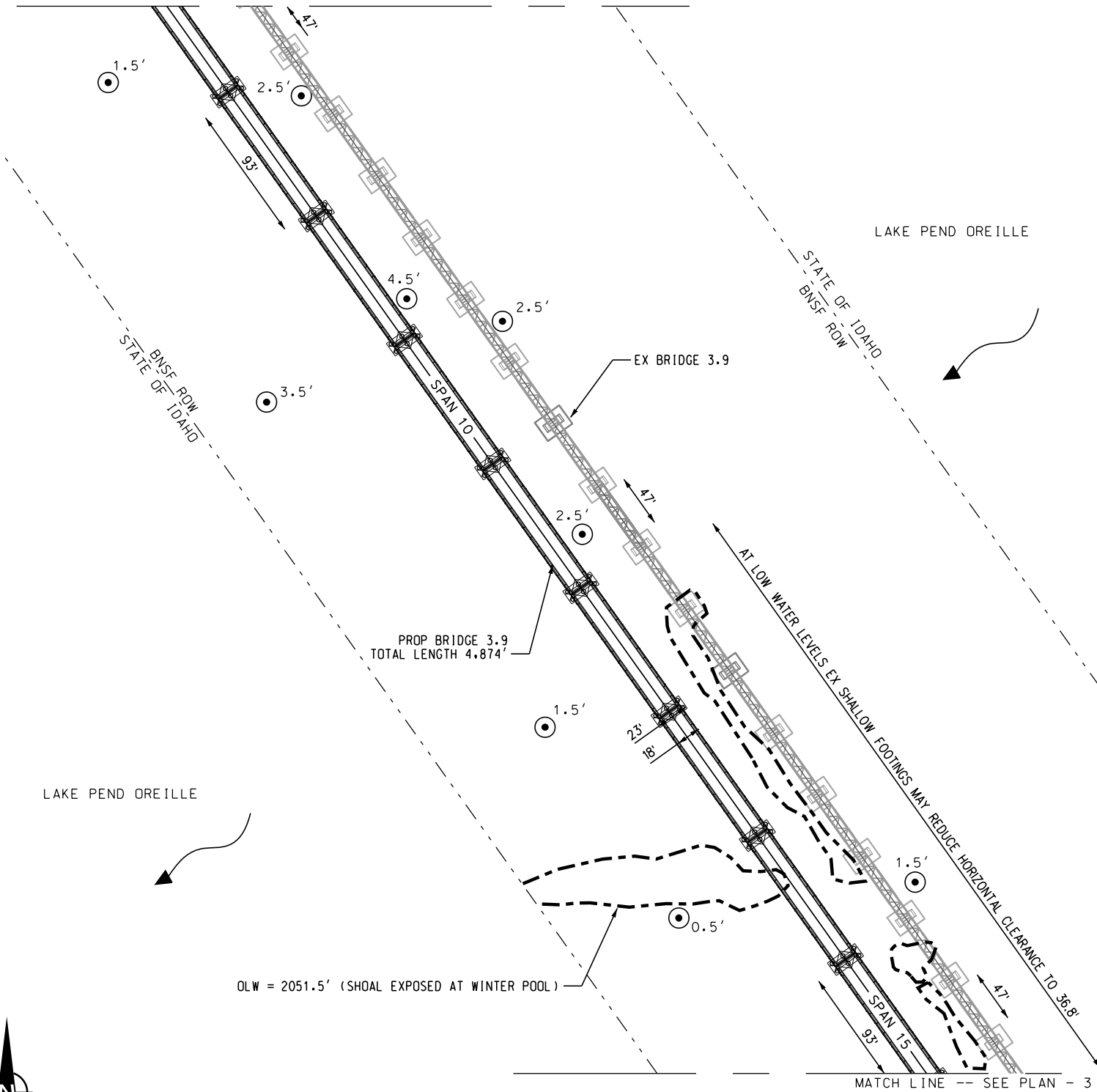

BASED ON: HANSON PROFESSIONAL SERVICES, INC. PRELIMINARY PLANS. ELEVATIONS ARE RELATIVE TO NAVD88. CONCEPTUAL PLANS UTILIZED TO OBTAIN U.S. COAST GUARD BRIDGE PERMIT

LEGEND		EXISTING CONDITIONS / PROPOSED WORK
<p>--- BNSF RIGHT-OF-WAY (ROW)</p> <p>--- ORDINARY LOW WATER (OLW)</p> <p>● 1.0' WATER DEPTH AT WINTER POOL</p>		<p><b>PROJECT:</b> BNSF / SANDPOINT JUNCTION CONNECTOR BRIDGE 3.9</p> <p><b>OWNER:</b> BNSF RAILWAY COMPANY</p> <p><b>CONSULTANT:</b> JACOBS ENGINEERING GROUP</p> <p><b>LOCATION:</b> BNSF BRIDGE 3.9 MONTANA DIVISION, KOOTENAI RIVER SUB, LINE SEGMENT 45, MP 3.9</p> <p><b>MILE POINT OF BRIDGE LOCATION FROM MOUTH:</b> 2.7</p> <p><b>WATERWAY:</b> LAKE PEND OREILLE</p> <p><b>CITY:</b> SANDPOINT <b>COUNTY:</b> BONNER <b>STATE:</b> IDAHO</p> <p><b>DATE:</b> 12/11/2018</p>
<p>12/11/2018 8:51:17 AM PLAN 3.9 BRIDGE 3.9 MONTANA DIVISION, KOOTENAI RIVER SUB, LINE SEGMENT 45, MP 3.9</p>		<p>SHEET 3 OF 18</p>



# PLAN VIEW - 3

## PROPOSED PERMANENT BRIDGE 3.9

1/16

USCG001301  
MATCH LINE -- SEE PLAN - 2

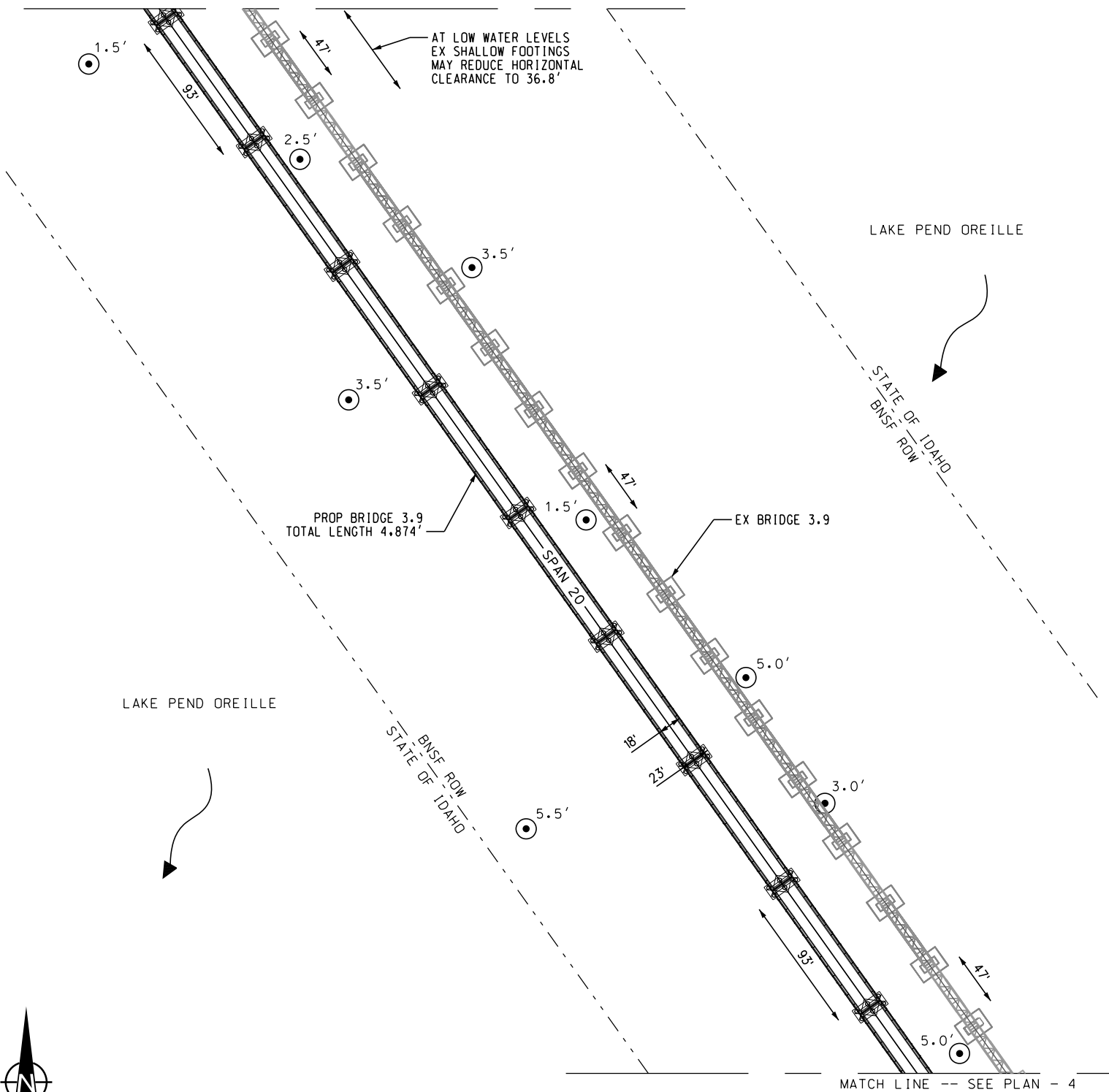

BASED ON: HANSON PROFESSIONAL SERVICES, INC. PRELIMINARY PLANS. ELEVATIONS ARE RELATIVE TO NAVD88. CONCEPTUAL PLANS UTILIZED TO OBTAIN U.S. COAST GUARD BRIDGE PERMIT

### LEGEND

- BNSF RIGHT-OF-WAY (ROW)
- ⊙ 1.0' WATER DEPTH AT WINTER POOL

### EXISTING CONDITIONS / PROPOSED WORK

**PROJECT:** BNSF / SANDPOINT JUNCTION CONNECTOR BRIDGE 3.9  
**OWNER:** BNSF RAILWAY COMPANY  
**CONSULTANT:** JACOBS ENGINEERING GROUP  
**LOCATION:** BNSF BRIDGE 3.9 MONTANA DIVISION, KOOTENAI RIVER SUB, LINE SEGMENT 45, MP 3.9  
**MILE POINT OF BRIDGE LOCATION FROM MOUTH:** 2.7  
**WATERWAY:** LAKE PEND OREILLE  
**CITY:** SANDPOINT **COUNTY:** BONNER **STATE:** IDAHO  
**DATE:** 12/11/2018

USCG001302

MATCH LINE -- SEE PLAN - 3

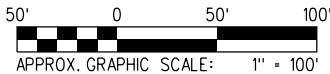
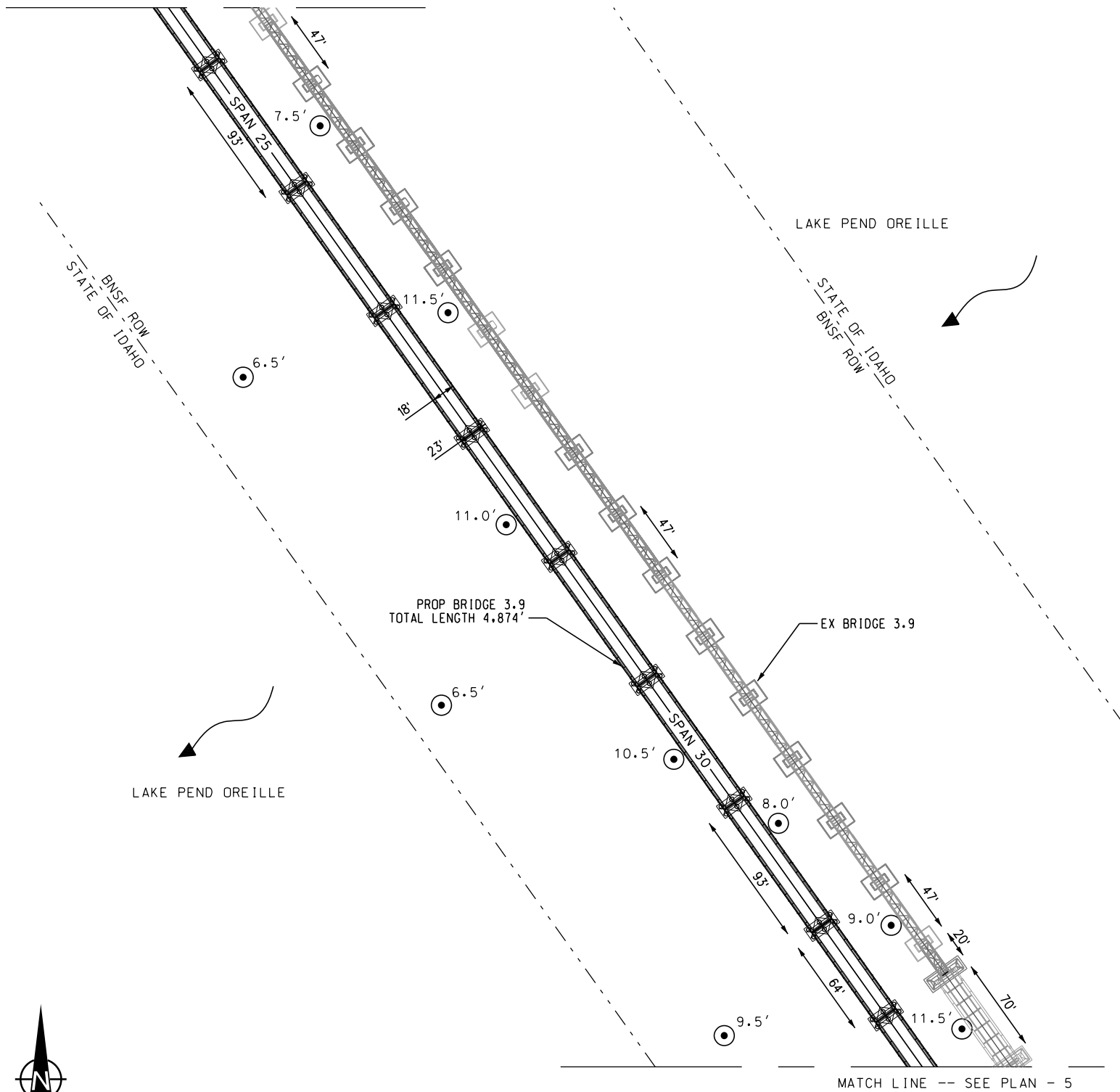

LEGEND

- BNSF RIGHT-OF-WAY (ROW)
- 1.0' WATER DEPTH AT WINTER POOL

EXISTING CONDITIONS / PROPOSED WORK

**PROJECT:** BNSF / SANDPOINT JUNCTION CONNECTOR BRIDGE 3.9  
**OWNER:** BNSF RAILWAY COMPANY  
**CONSULTANT:** JACOBS ENGINEERING GROUP  
**LOCATION:** BNSF BRIDGE 3.9 MONTANA DIVISION, KOOTENAI RIVER SUB, LINE SEGMENT 45, MP 3.9  
**MILE POINT OF BRIDGE LOCATION FROM MOUTH:** 2.7  
**WATERWAY:** LAKE PEND OREILLE  
**CITY:** SANDPOINT **COUNTY:** BONNER **STATE:** IDAHO  
**DATE:** 12/11/2018



USCG001303  
MATCH LINE -- SEE PLAN - 4

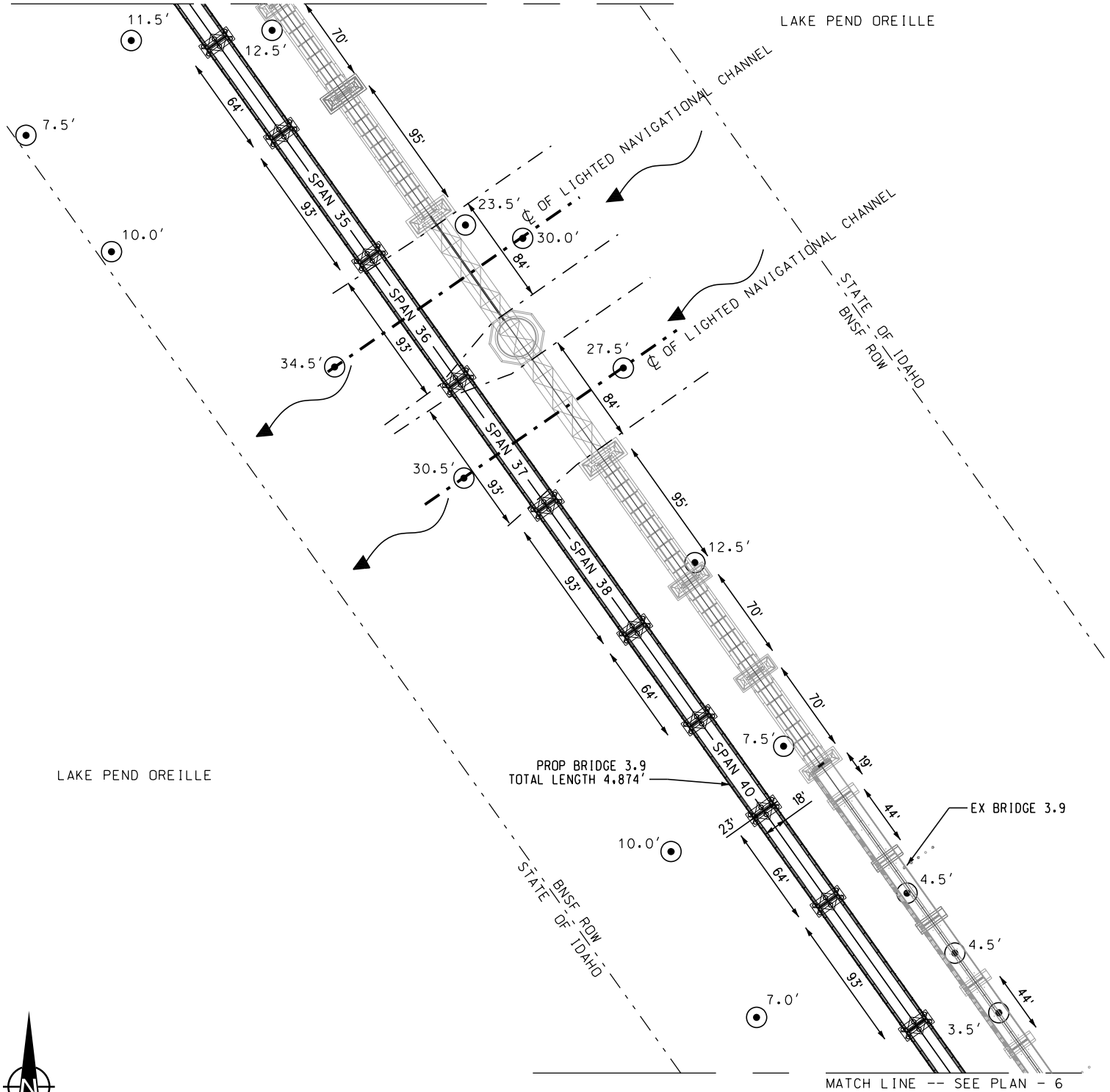

BASED ON: HANSON PROFESSIONAL SERVICES, INC. PRELIMINARY PLANS. ELEVATIONS ARE RELATIVE TO NAVD88. CONCEPTUAL PLANS UTILIZED TO OBTAIN U.S. COAST GUARD BRIDGE PERMIT

LEGEND

- BNSF RIGHT-OF-WAY (ROW)
- - - CENTERLINE OF NAVIGATIONAL CHANNEL
- - - LIMITS OF NAVIGATIONAL CHANNEL
- ⊙ 1.0' WATER DEPTH AT WINTER POOL

EXISTING CONDITIONS / PROPOSED WORK

**PROJECT:** BNSF / SANDPOINT JUNCTION CONNECTOR BRIDGE 3.9  
**OWNER:** BNSF RAILWAY COMPANY  
**CONSULTANT:** JACOBS ENGINEERING GROUP  
**LOCATION:** BNSF BRIDGE 3.9 MONTANA DIVISION, KOOTENAI RIVER SUB. LINE SEGMENT 45, MP 3.9  
**MILE POINT OF BRIDGE LOCATION FROM MOUTH:** 2.7  
**WATERWAY:** LAKE PEND OREILLE  
**CITY:** SANDPOINT **COUNTY:** BONNER **STATE:** IDAHO  
**DATE:** 12/11/2018

USCG 1364 -- SEE PLAN - 5

PROP BRIDGE 3.9  
TOTAL LENGTH 4.874'

EX BRIDGE 3.9

LAKE PEND OREILLE

STATE OF IDAHO  
BNSF ROW

STATE OF IDAHO  
BNSF ROW

BERRYMAN, ALAN A  
2481 BOTTLE BAY ROAD  
BNSF ROW

LAKE PEND OREILLE

SPAN 49 AT OHW: 36'

OHW = 2062.5'  
(SUMMER POOL SHORELINE)

OLW = 2051.5'  
(WINTER POOL SHORELINE)

50 CY OF NEARSHORE  
FILL (PERMANENT)

PROP OHW

EX OHW

PROP GRADING LIMITS

FILL

FILL

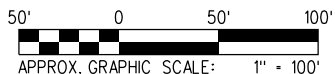

BASED ON: HANSON PROFESSIONAL SERVICES, INC. PRELIMINARY PLANS. ELEVATIONS ARE RELATIVE TO NAVD88. CONCEPTUAL PLANS UTILIZED TO OBTAIN U.S. COAST GUARD BRIDGE PERMIT

- LEGEND**
- BNSF RIGHT-OF-WAY (ROW)
  - SHORELINE (SUMMER AND WINTER POOL)
  - STRUCTURE (ROADS, DOCKS)
  - 1.0' WATER DEPTH AT WINTER POOL

**EXISTING CONDITIONS / PROPOSED WORK**

**PROJECT:** BNSF / SANDPOINT JUNCTION CONNECTOR BRIDGE 3.9  
**OWNER:** BNSF RAILWAY COMPANY  
**CONSULTANT:** JACOBS ENGINEERING GROUP  
**LOCATION:** BNSF BRIDGE 3.9 MONTANA DIVISION, KOOTENAI RIVER SUB, LINE SEGMENT 45, MP 3.9  
**MILE POINT OF BRIDGE LOCATION FROM MOUTH:** 2.7  
**WATERWAY:** LAKE PEND OREILLE  
**CITY:** SANDPOINT **COUNTY:** BONNER **STATE:** IDAHO  
**DATE:** 12/11/2018

SPOKANE, WA 1305



# PROPOSED PERMANENT BRIDGE 3.9 ELEVATION VIEW - 01

SANDPOINT, ID

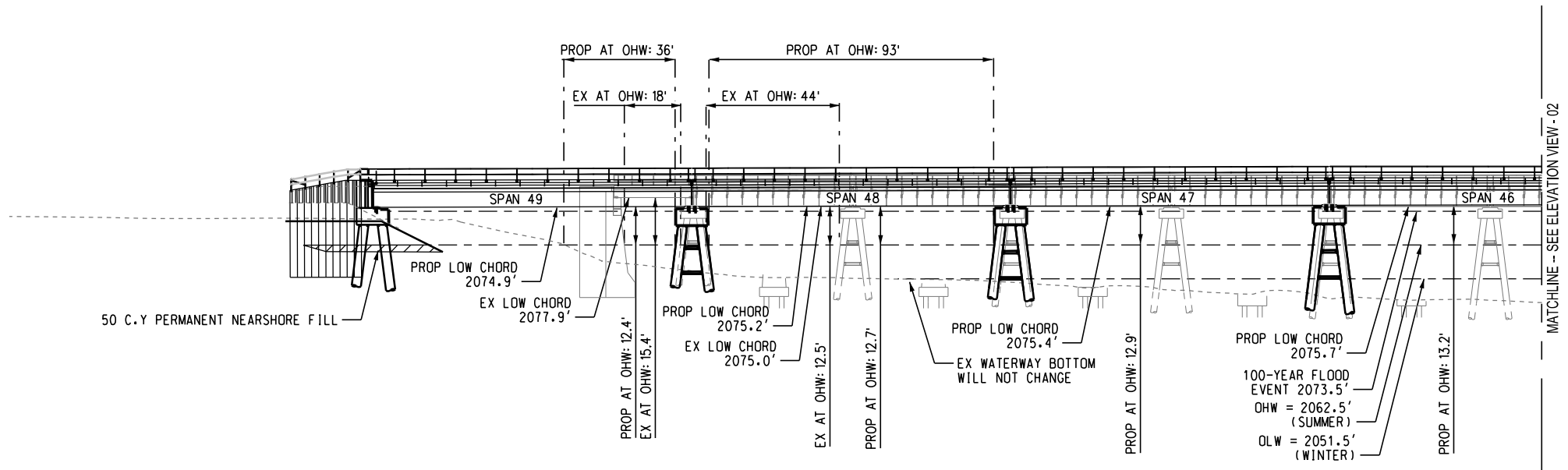

APPROX. GRAPHIC SCALE: 1" = 50'

BASED ON: HANSON PROFESSIONAL SERVICES, INC. PRELIMINARY PLANS. ELEVATIONS ARE RELATIVE TO NAVD88. CONCEPTUAL PLANS UTILIZED TO OBTAIN U.S. COAST GUARD BRIDGE PERMIT

## LEGEND

- LIMITS OF NAVIGATIONAL CHANNEL
- EXISTING STRUCTURE
- PROPOSED STRUCTURE

## EXISTING CONDITIONS / PROPOSED WORK

**PROJECT:** BNSF / SANDPOINT JUNCTION CONNECTOR BRIDGE 3.9  
**OWNER:** BNSF RAILWAY COMPANY  
**CONSULTANT:** JACOBS ENGINEERING GROUP  
**LOCATION:** BNSF BRIDGE 3.9 MONTANA DIVISION, KOOTENAI RIVER SUB, LINE SEGMENT 45, MP 3.9  
**MILE POINT OF BRIDGE LOCATION FROM MOUTH:** 2.7  
**WATERWAY:** LAKE PEND OREILLE  
**CITY:** SANDPOINT **COUNTY:** BONNER **STATE:** IDAHO  
**DATE:** 12/11/2018

SPOKANE, WA

# PROPOSED PERMANENT BRIDGE 3.9 ELEVATION VIEW - 02

SANDPOINT, ID

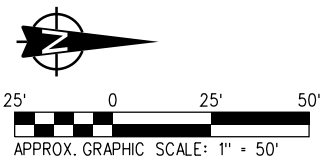
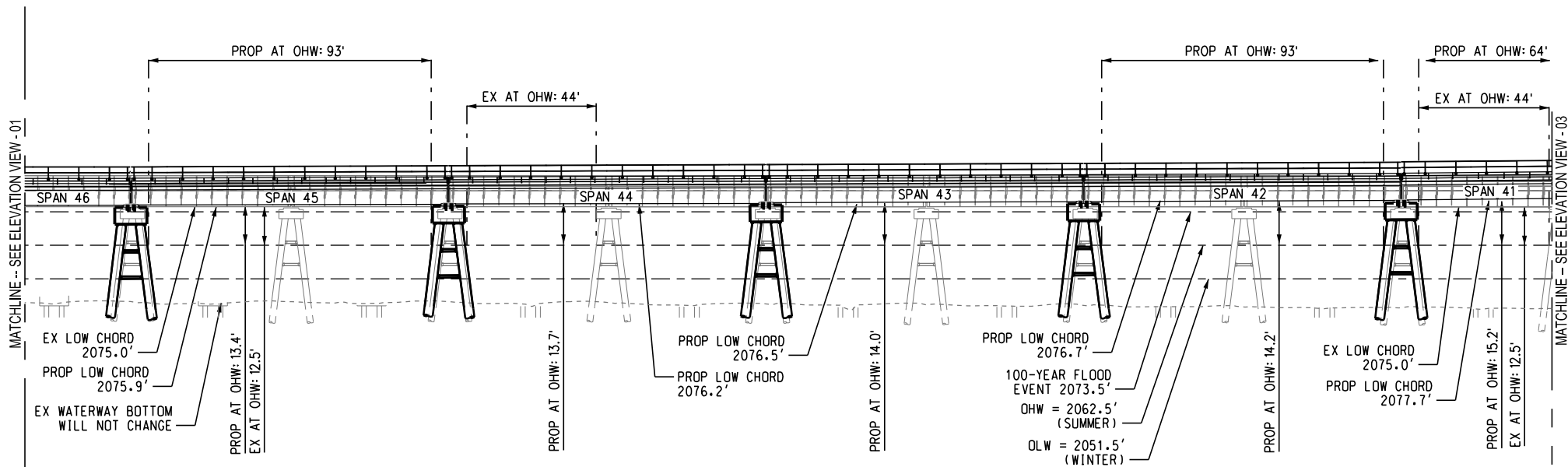

BASED ON: HANSON PROFESSIONAL SERVICES, INC. PRELIMINARY PLANS. ELEVATIONS ARE RELATIVE TO NAVD88. CONCEPTUAL PLANS UTILIZED TO OBTAIN U.S. COAST GUARD BRIDGE PERMIT

## LEGEND

- LIMITS OF NAVIGATIONAL CHANNEL
- EXISTING STRUCTURE
- PROPOSED STRUCTURE

## EXISTING CONDITIONS / PROPOSED WORK

**PROJECT:** BNSF / SANDPOINT JUNCTION CONNECTOR BRIDGE 3.9  
**OWNER:** BNSF RAILWAY COMPANY  
**CONSULTANT:** JACOBS ENGINEERING GROUP  
**LOCATION:** BNSF BRIDGE 3.9 MONTANA DIVISION, KOOTENAI RIVER SUB, LINE SEGMENT 45, MP 3.9  
**MILE POINT OF BRIDGE LOCATION FROM MOUTH:** 2.7  
**WATERWAY:** LAKE PEND OREILLE  
**CITY:** SANDPOINT **COUNTY:** BONNER **STATE:** IDAHO  
**DATE:** 12/11/2018

SPOKANE, WA 1307

# PROPOSED PERMANENT BRIDGE 3.9 ELEVATION VIEW - 03

SANDPOINT, ID

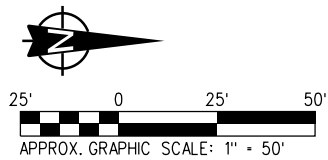
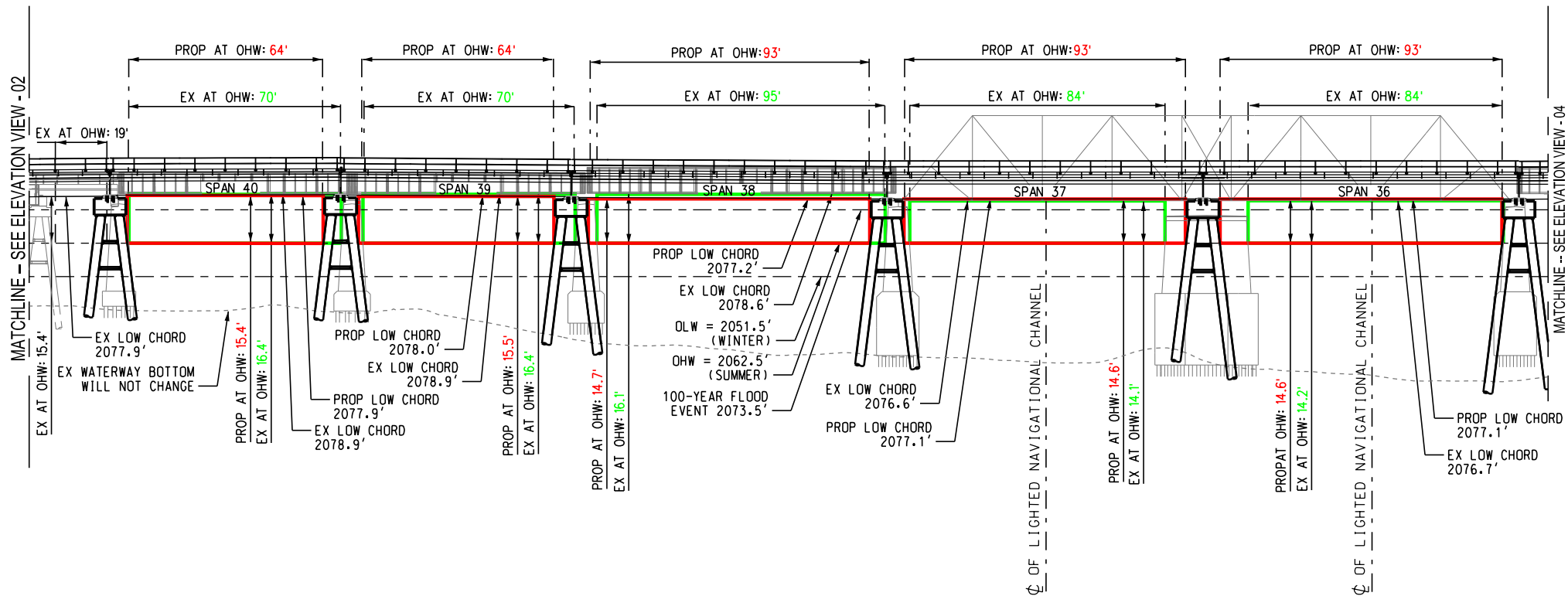

BASED ON: HANSON PROFESSIONAL SERVICES, INC. PRELIMINARY PLANS. ELEVATIONS ARE RELATIVE TO NAVD88. CONCEPTUAL PLANS UTILIZED TO OBTAIN U.S. COAST GUARD BRIDGE PERMIT

## LEGEND

- CENTERLINE OF NAVIGATIONAL CHANNEL
- EXISTING STRUCTURE
- PROPOSED STRUCTURE
- EXISTING NAVIGATIONAL ENVELOPE
- PROPOSED NAVIGATIONAL ENVELOPE

## EXISTING CONDITIONS / PROPOSED WORK

**PROJECT:** BNSF / SANDPOINT JUNCTION CONNECTOR BRIDGE 3.9  
**OWNER:** BNSF RAILWAY COMPANY  
**CONSULTANT:** JACOBS ENGINEERING GROUP  
**LOCATION:** BNSF BRIDGE 3.9 MONTANA DIVISION, KOOTENAI RIVER SUB, LINE SEGMENT 45, MP 3.9  
**MILE POINT OF BRIDGE LOCATION FROM MOUTH:** 2.7  
**WATERWAY:** LAKE PEND OREILLE  
**CITY:** SANDPOINT **COUNTY:** BONNER **STATE:** IDAHO  
**DATE:** 12/11/2018

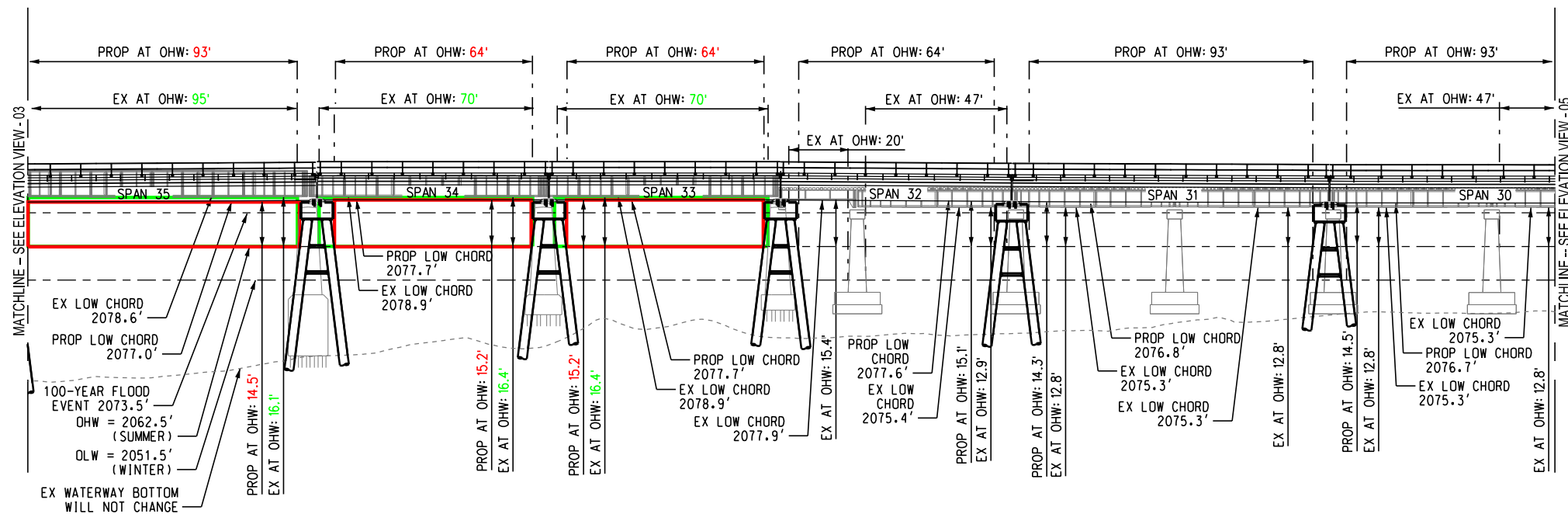

BASED ON: HANSON PROFESSIONAL SERVICES, INC. PRELIMINARY PLANS. ELEVATIONS ARE RELATIVE TO NAVD88. CONCEPTUAL PLANS UTILIZED TO OBTAIN U.S. COAST GUARD BRIDGE PERMIT

### LEGEND

- |  |                                |
|--|--------------------------------|
| - - - - -  | LIMITS OF NAVIGATIONAL CHANNEL |
| —————  | EXISTING STRUCTURE             |
| —————  | PROPOSED STRUCTURE             |
| <span style="border: 2px solid green; display: inline-block; width: 50px; height: 15px;"></span> | EXISTING NAVIGATIONAL ENVELOPE |
| <span style="border: 2px solid red; display: inline-block; width: 50px; height: 15px;"></span>   | PROPOSED NAVIGATIONAL ENVELOPE |

## EXISTING CONDITIONS / PROPOSED WORK

**PROJECT:** BNSF / SANDPOINT JUNCTION CONNECTOR BRIDGE 3.9  
**OWNER:** BNSF RAILWAY COMPANY  
**CONSULTANT:** JACOBS ENGINEERING GROUP  
**LOCATION:** BNSF BRIDGE 3.9 MONTANA DIVISION, KOOTENAI  
 RIVER SUB, LINE SEGMENT 45, MP 3.9  
**MILE POINT OF BRIDGE LOCATION FROM MOUTH:** 2.7  
**WATERWAY:** LAKE PEND OREILLE  
**CITY:** SANDPOINT **COUNTY:** BONNER **STATE:** IDAHO  
**DATE:** 12/11/2018

SPOKANE, WA 1309



# PROPOSED PERMANENT BRIDGE 3.9 ELEVATION VIEW - 05

SANDPOINT, ID

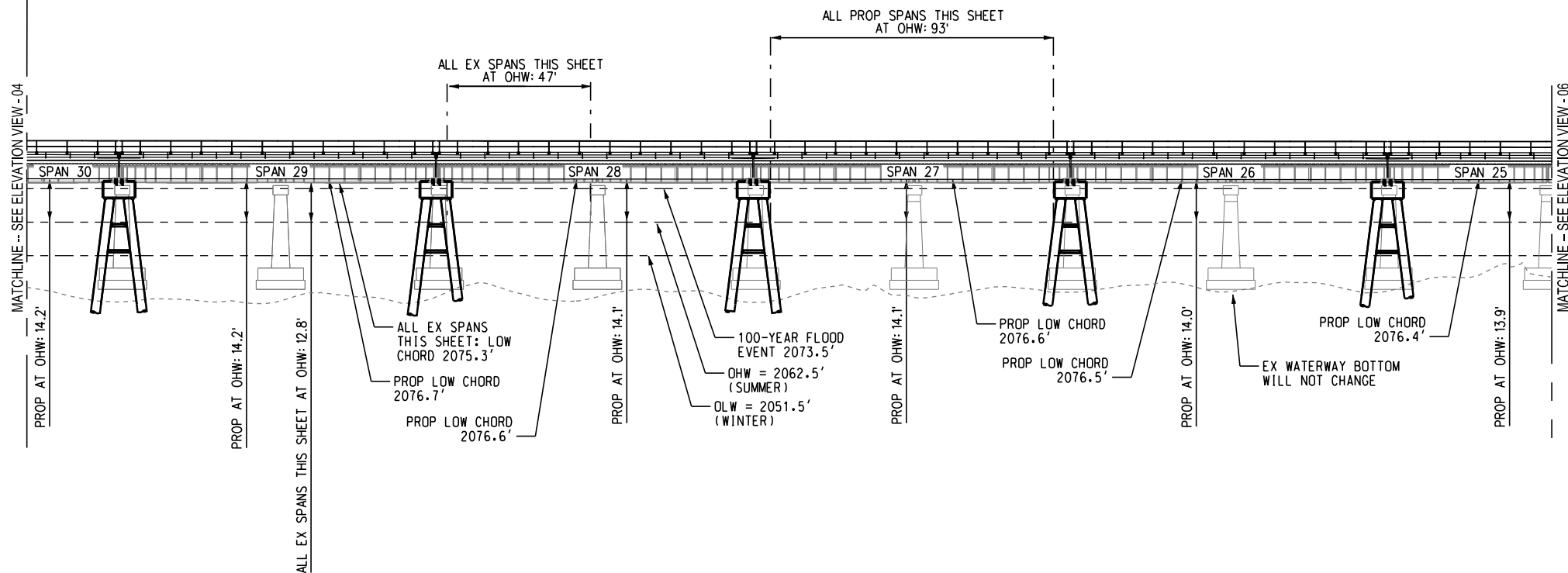

BASED ON: HANSON PROFESSIONAL SERVICES, INC. PRELIMINARY PLANS. ELEVATIONS ARE RELATIVE TO NAVD88. CONCEPTUAL PLANS UTILIZED TO OBTAIN U.S. COAST GUARD BRIDGE PERMIT

## LEGEND

- LIMITS OF NAVIGATIONAL CHANNEL
- EXISTING STRUCTURE
- PROPOSED STRUCTURE

## EXISTING CONDITIONS / PROPOSED WORK

**PROJECT:** BNSF / SANDPOINT JUNCTION CONNECTOR BRIDGE 3.9  
**OWNER:** BNSF RAILWAY COMPANY  
**CONSULTANT:** JACOBS ENGINEERING GROUP  
**LOCATION:** BNSF BRIDGE 3.9 MONTANA DIVISION, KOOTENAI RIVER SUB, LINE SEGMENT 45, MP 3.9  
**MILE POINT OF BRIDGE LOCATION FROM MOUTH:** 2.7  
**WATERWAY:** LAKE PEND OREILLE  
**CITY:** SANDPOINT **COUNTY:** BONNER **STATE:** IDAHO  
**DATE:** 12/11/2018



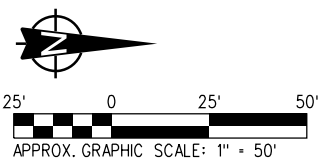
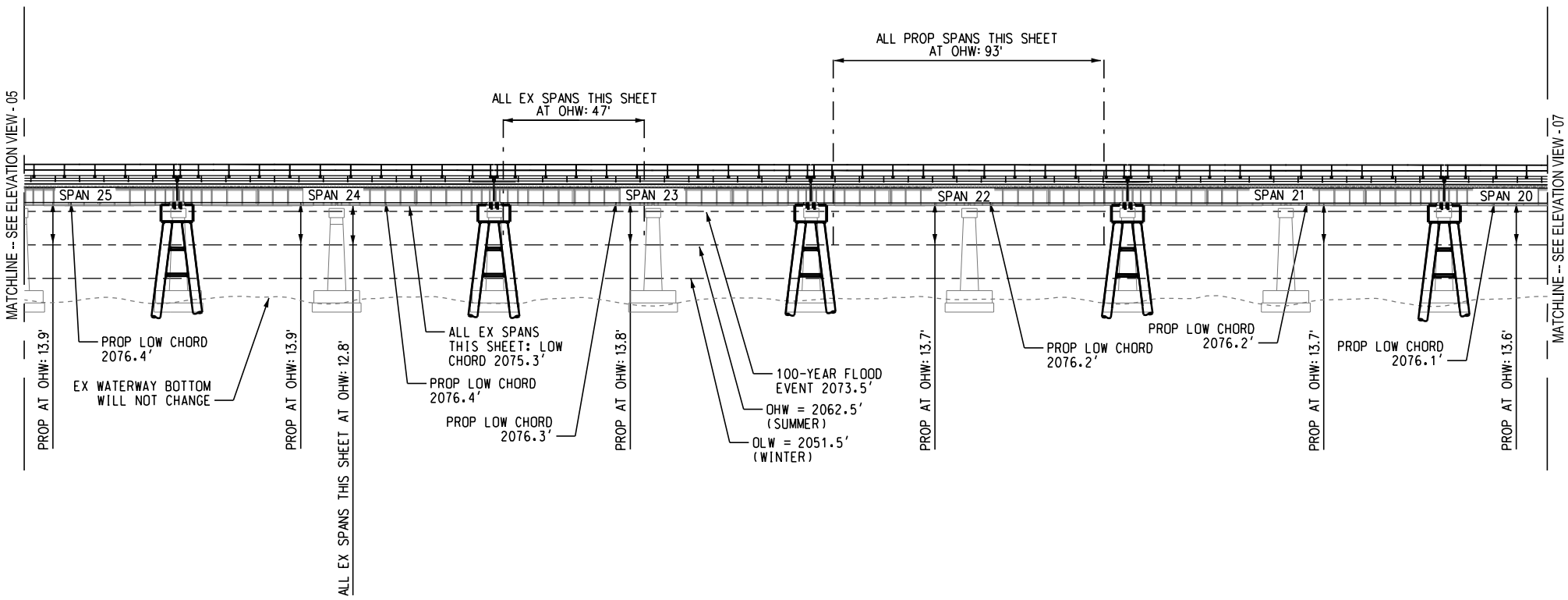

BASED ON: HANSON PROFESSIONAL SERVICES, INC. PRELIMINARY PLANS. ELEVATIONS ARE RELATIVE TO NAVD88. CONCEPTUAL PLANS UTILIZED TO OBTAIN U.S. COAST GUARD BRIDGE PERMIT

LEGEND

- - - - - LIMITS OF NAVIGATIONAL CHANNEL
- EXISTING STRUCTURE
- PROPOSED STRUCTURE

EXISTING CONDITIONS / PROPOSED WORK

PROJECT: BNSF / SANDPOINT JUNCTION CONNECTOR BRIDGE 3.9  
OWNER: BNSF RAILWAY COMPANY  
CONSULTANT: JACOBS ENGINEERING GROUP  
LOCATION: BNSF BRIDGE 3.9 MONTANA DIVISION, KOOTENAI RIVER SUB. LINE SEGMENT 45, MP 3.9  
MILE POINT OF BRIDGE LOCATION FROM MOUTH: 2.7  
WATERWAY: LAKE PEND OREILLE  
CITY: SANDPOINT COUNTY: BONNER STATE: IDAHO  
DATE: 12/11/2018

PROPOSED PERMANENT BRIDGE 3.9  
ELEVATION VIEW - 07

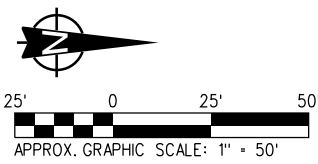
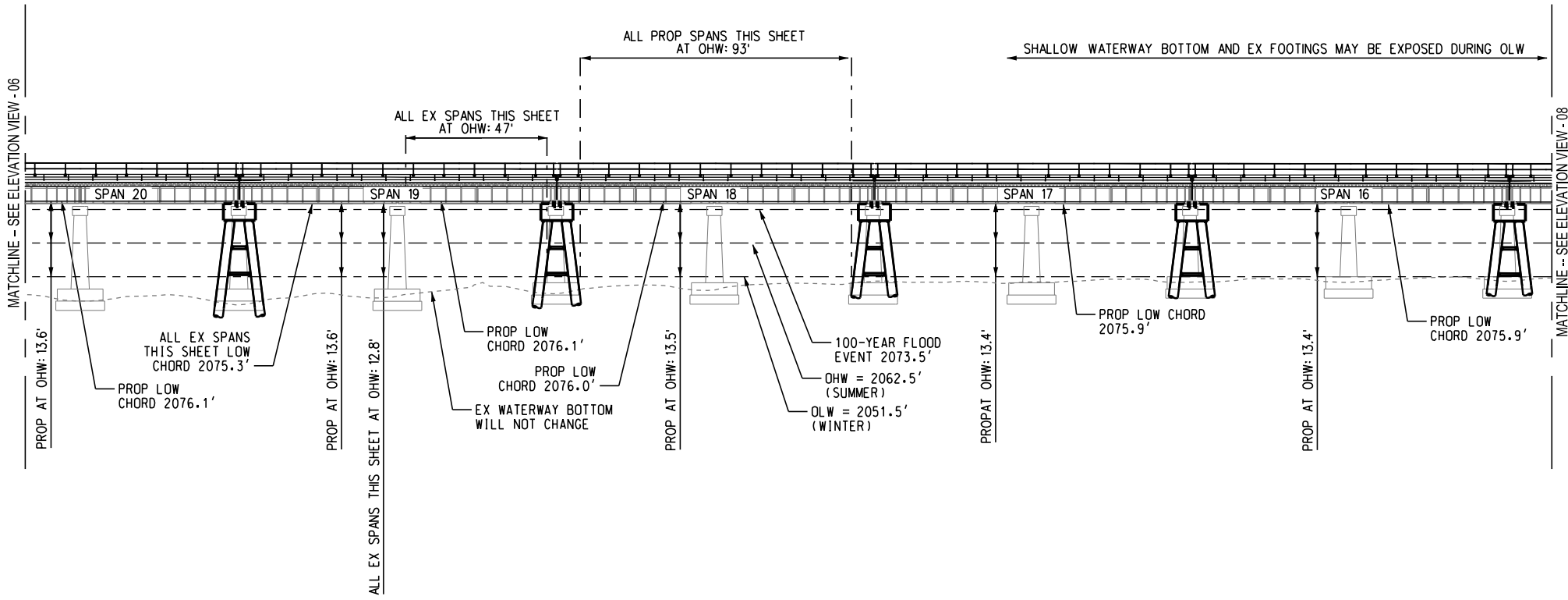

BASED ON: HANSON PROFESSIONAL SERVICES, INC. PRELIMINARY PLANS. ELEVATIONS ARE RELATIVE TO NAVD88. CONCEPTUAL PLANS UTILIZED TO OBTAIN U.S. COAST GUARD BRIDGE PERMIT

LEGEND		EXISTING CONDITIONS / PROPOSED WORK
---	LIMITS OF NAVIGATIONAL CHANNEL	
---	EXISTING STRUCTURE	<p><b>PROJECT:</b> BNSF / SANDPOINT JUNCTION CONNECTOR BRIDGE 3.9 <b>OWNER:</b> BNSF RAILWAY COMPANY <b>CONSULTANT:</b> JACOBS ENGINEERING GROUP <b>LOCATION:</b> BNSF BRIDGE 3.9 MONTANA DIVISION, KOOTENAI RIVER SUB. LINE SEGMENT 45, MP 3.9 <b>MILE POINT OF BRIDGE LOCATION FROM MOUTH:</b> 2.7 <b>WATERWAY:</b> LAKE PEND OREILLE <b>CITY:</b> SANDPOINT <b>COUNTY:</b> BONNER <b>STATE:</b> IDAHO <b>DATE:</b> 12/11/2018</p>
---	PROPOSED STRUCTURE	
---		
---		
---		
		SHEET 14 OF 18

SPOKANE, WA 1312

# PROPOSED PERMANENT BRIDGE 3.9 ELEVATION VIEW - 08

SANDPOINT, ID

SHALLOW WATERWAY BOTTOM AND EX FOOTINGS MAY BE EXPOSED DURING OLW

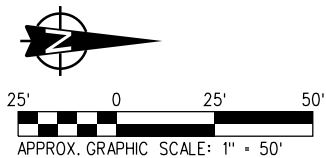
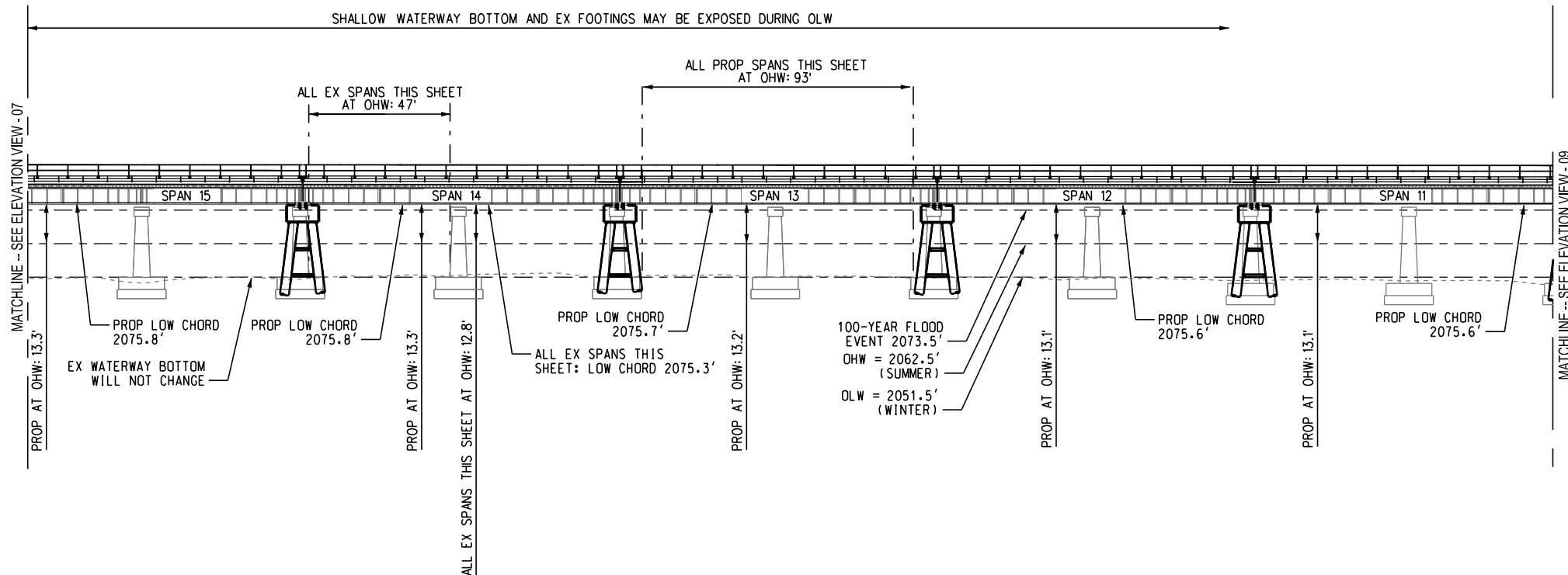

BASED ON: HANSON PROFESSIONAL SERVICES, INC. PRELIMINARY PLANS. ELEVATIONS ARE RELATIVE TO NAVD88. CONCEPTUAL PLANS UTILIZED TO OBTAIN U.S. COAST GUARD BRIDGE PERMIT

## LEGEND

- LIMITS OF NAVIGATIONAL CHANNEL
- EXISTING STRUCTURE
- PROPOSED STRUCTURE

## EXISTING CONDITIONS / PROPOSED WORK

**PROJECT:** BNSF / SANDPOINT JUNCTION CONNECTOR BRIDGE 3.9  
**OWNER:** BNSF RAILWAY COMPANY  
**CONSULTANT:** JACOBS ENGINEERING GROUP  
**LOCATION:** BNSF BRIDGE 3.9 MONTANA DIVISION, KOOTENAI RIVER SUB, LINE SEGMENT 45, MP 3.9  
**MILE POINT OF BRIDGE LOCATION FROM MOUTH:** 2.7  
**WATERWAY:** LAKE PEND OREILLE  
**CITY:** SANDPOINT **COUNTY:** BONNER **STATE:** IDAHO  
**DATE:** 12/11/2018

**SPOKANE, WA**

PROPOSED PERMANENT BRIDGE 3.9  
ELEVATION VIEW - 09

**SANDPOINT, ID**

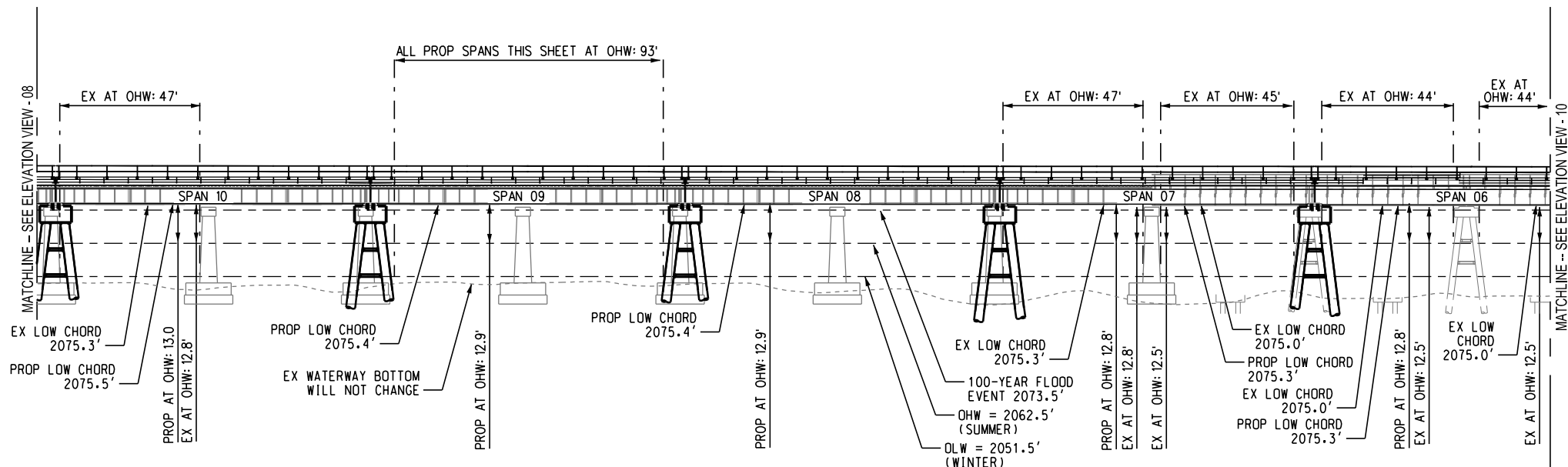

25' 0 25' 50'



APPROX. GRAPHIC SCALE: 1" = 50'

BASED ON: HANSON PROFESSIONAL SERVICES, INC. PRELIMINARY PLANS. ELEVATIONS ARE RELATIVE TO NAVD88. CONCEPTUAL PLANS UTILIZED TO OBTAIN U.S. COAST GUARD BRIDGE PERMIT

### LEGEND

- - - - - LIMITS OF NAVIGATIONAL CHANNEL  
 \_\_\_\_\_ EXISTING STRUCTURE  
 \_\_\_\_\_ PROPOSED STRUCTURE

EXISTING CONDITIONS / PROPOSED WORK	

**PROJECT:** BNSF / SANDPOINT JUNCTION CONNECTOR BRIDGE 3.9  
**OWNER:** BNSF RAILWAY COMPANY  
**CONSULTANT:** JACOBS ENGINEERING GROUP  
**LOCATION:** BNSF BRIDGE 3.9 MONTANA DIVISION, KOOTENAI RIVER SUB, LINE SEGMENT 45, MP 3.9  
**MILE POINT OF BRIDGE LOCATION FROM MOUTH:** 2.7  
**WATERWAY:** LAKE PEND OREILLE  
**CITY:** SANDPOINT **COUNTY:** BONNER **STATE:** IDAHO  
**DATE:** 12/11/2018

12/11/2018 9:19:23 AM \$USER\$  
3: W3X76600\6000ISC\620DESIGN\JARPA\SPJ\_CG\_BR3-9\_Elev-09 - PN.dgn

SPOKANE, WA

# PROPOSED PERMANENT BRIDGE 3.9 ELEVATION VIEW - 10

SANDPOINT, ID

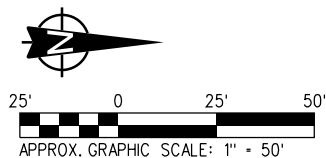
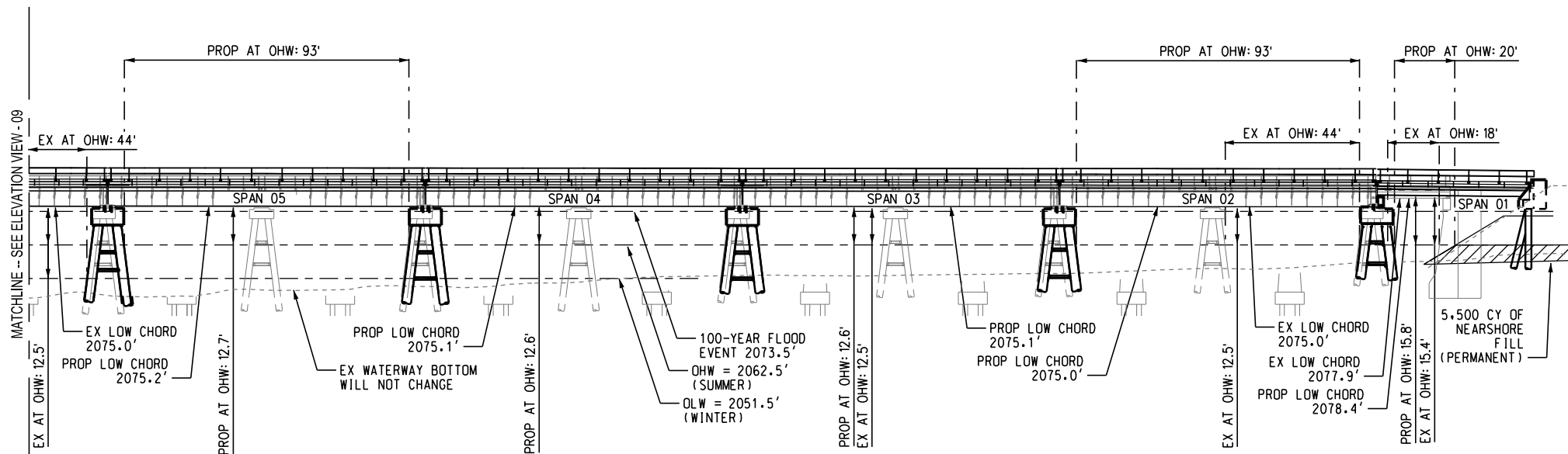

BASED ON: HANSON PROFESSIONAL SERVICES, INC. PRELIMINARY PLANS. ELEVATIONS ARE RELATIVE TO NAVD88. CONCEPTUAL PLANS UTILIZED TO OBTAIN U.S. COAST GUARD BRIDGE PERMIT

## LEGEND

- LIMITS OF NAVIGATIONAL CHANNEL
- EXISTING STRUCTURE
- PROPOSED STRUCTURE

## EXISTING CONDITIONS / PROPOSED WORK

**PROJECT:** BNSF / SANDPOINT JUNCTION CONNECTOR BRIDGE 3.9  
**OWNER:** BNSF RAILWAY COMPANY  
**CONSULTANT:** JACOBS ENGINEERING GROUP  
**LOCATION:** BNSF BRIDGE 3.9 MONTANA DIVISION, KOOTENAI RIVER SUB. LINE SEGMENT 45, MP 3.9  
**MILE POINT OF BRIDGE LOCATION FROM MOUTH:** 2.7  
**WATERWAY:** LAKE PEND OREILLE  
**CITY:** SANDPOINT **COUNTY:** BONNER **STATE:** IDAHO  
**DATE:** 12/11/2018

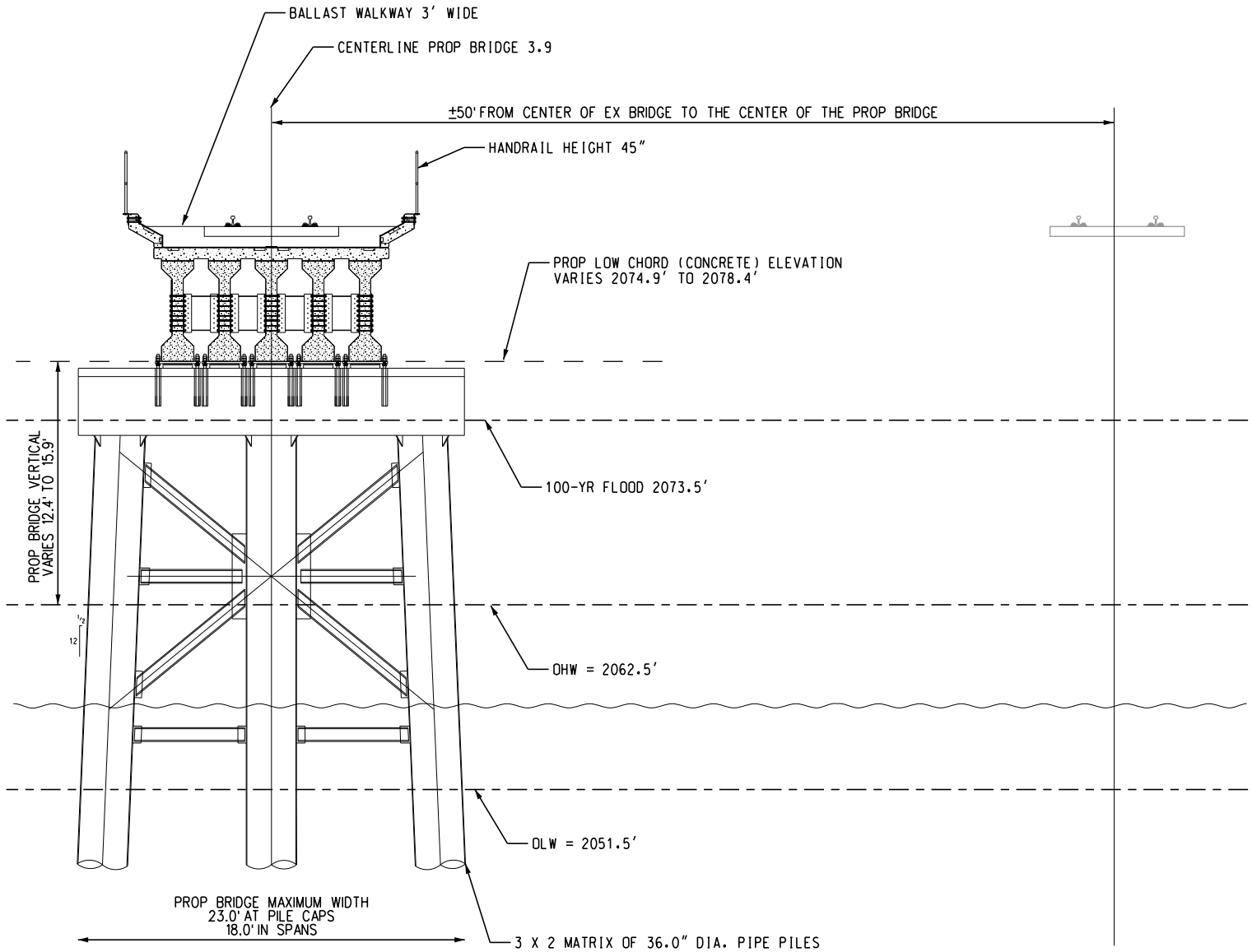

BASED ON: HANSON PROFESSIONAL SERVICES, INC. PRELIMINARY PLANS. ELEVATIONS ARE RELATIVE TO NAVD88. CONCEPTUAL PLANS UTILIZED TO OBTAIN U.S. COAST GUARD BRIDGE PERMIT

## EXISTING CONDITIONS / PROPOSED WORK

**PROJECT:** BNSF / SANDPOINT JUNCTION CONNECTOR BRIDGE 3.9  
**OWNER:** BNSF RAILWAY COMPANY  
**CONSULTANT:** JACOBS ENGINEERING GROUP  
**LOCATION:** BNSF BRIDGE 3.9 MONTANA DIVISION, KOOTENAI RIVER SUB, LINE SEGMENT 45, MP 3.9  
**MILE POINT OF BRIDGE LOCATION FROM MOUTH:** 2.7  
**WATERWAY:** LAKE PEND OREILLE  
**CITY:** SANDPOINT **COUNTY:** BONNER **STATE:** IDAHO  
**DATE:** 12/11/2018