



BRIDGE PERMIT

7 MAY 2025

(2-25-1)

WHEREAS by Title V of an act of Congress approved August 2, 1946, entitled "General Bridge Act of 1946," as amended (33 U.S.C. §§ 525-533), the consent of Congress was granted for the construction, maintenance and operation of bridges and approaches thereto over the navigable waters of the United States;

AND WHEREAS the Secretary of Homeland Security has delegated the authority of Section 502(b) of that act to the Commandant, U.S. Coast Guard by Department of Homeland Security Delegation Number: 0170.1;

AND WHEREAS before construction is commenced, the Commandant must approve the location and plans of any such bridge and may impose any specific conditions relating to the construction, maintenance and operation of the structure deemed necessary in the interest of public navigation, such conditions to have the force of law;

AND WHEREAS the - **NEW JERSEY TURNPIKE AUTHORITY** - has submitted for approval the location and plans of dual bridges to be constructed across Newark Bay between Newark and Bayonne, New Jersey;

NOW THEREFORE, This is to certify that the location and plans dated 4 March 2025 are hereby approved by the Commandant, subject to the following conditions:

1. No deviation from the approved plans may be made either before or after completion of the structures unless the modification of said plans has previously been submitted to and received the approval of the Commandant.

2. The construction of falsework, pilings, cofferdams or other obstructions, if required, and shall be in accordance with plans submitted to and approved by the Commander, First Coast Guard District, prior to construction of the bridges. All work shall be so conducted that the free navigation of the waterway is not unreasonably interfered with, and the present navigable depths are not impaired. Timely notice of any and all events that may affect navigation shall be given to the District Commander during construction of the bridges. The channel or channels through the structures shall be promptly cleared of all obstructions placed therein or caused by the construction of the bridges to the satisfaction of the District Commander, when in the judgment of the District Commander the construction work has reached a point where such action should be taken.

3. Issuance of this permit does not relieve the permittee of the obligation or responsibility for compliance with the provisions of any other law or regulation as may be under the jurisdiction of any Federal, state, or local authority having cognizance of any aspect of the location, construction or maintenance of said bridges.

4. A bridge protective system shall be installed and maintained in a good and legible condition by the at the expense of the owner of the bridges as shown on approved plan sheets 4 and 7 (of 8) dated 4 March 2025. Said installation and maintenance shall be for the safety of navigation.

5. Clearance gauges shall be installed and maintained in a good and legible condition by and at the expense of the owner of the bridges when so required by the District Commander. The type of gauges and the locations in which they are installed will be submitted to the District Commander for approval.

6. All parts of the existing to-be-replaced Vincent R. Casiano Memorial Bridge across Newark Bay, mile 4.0, not utilized in the new bridges shall be removed down to a minimum of two feet below the natural bottom of the waterway. All other parts shall be removed down to or below the natural ground line. The waterway shall be cleared to the satisfaction of the District Commander. Such removal and clearance shall be completed when the District Commander determines that the construction of the new bridges, mile 4.0, have reached a point where such action should be taken.

7. When the proposed bridges are no longer used for transportation purposes, they shall be removed in their entirety or to elevations deemed appropriate by the District Commander and the waterway cleared to the satisfaction of the District Commander. Such removals and clearances shall be completed by and at the expense of the owner of the bridges upon due notice from the District Commander.

8. The approval hereby granted shall cease and be null and void unless construction of the bridges is commenced within five years and completed within eight years after the date of this permit.

Brian L. Dunn
Chief, Office of Bridge Programs
U.S. Coast Guard
By direction of the Commandant

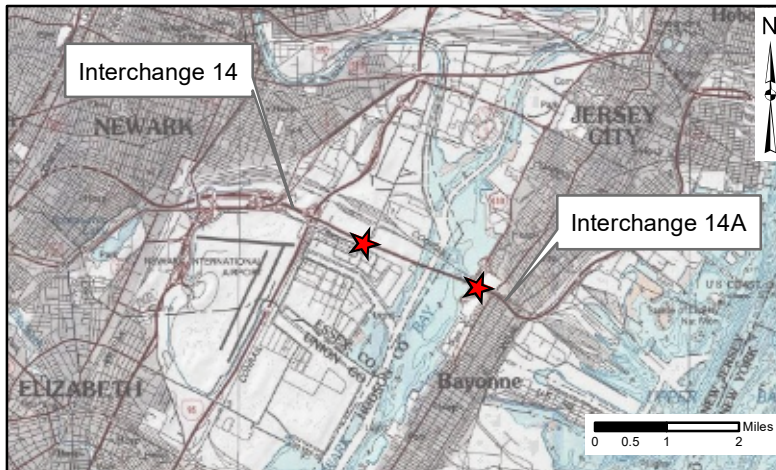

VICINITY MAP

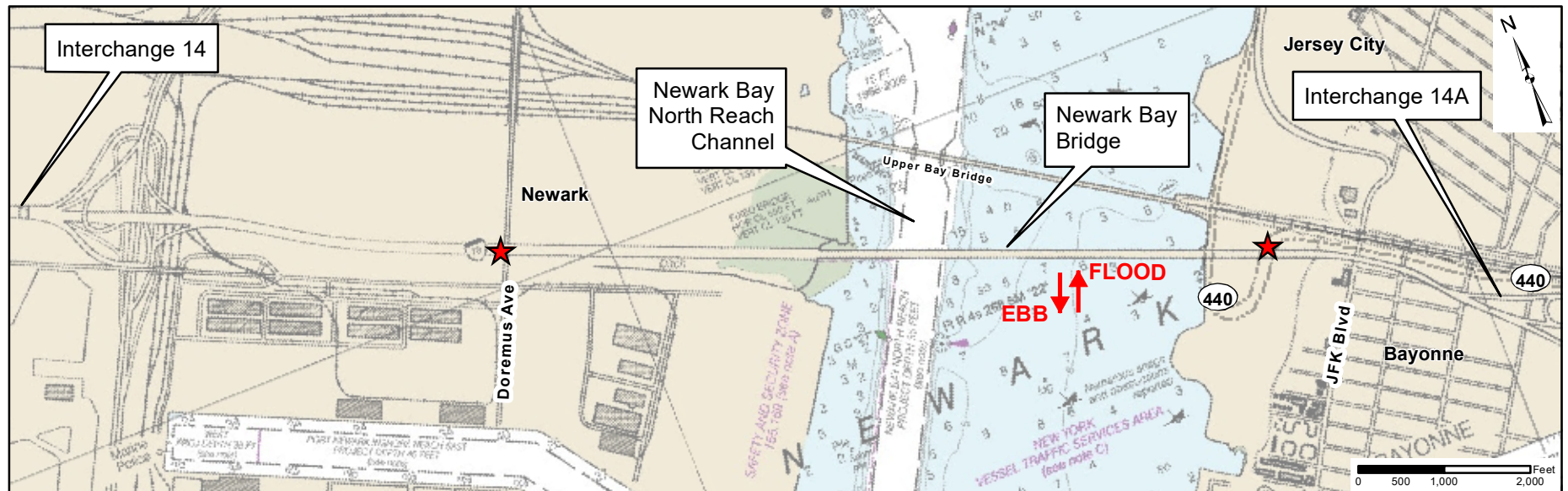
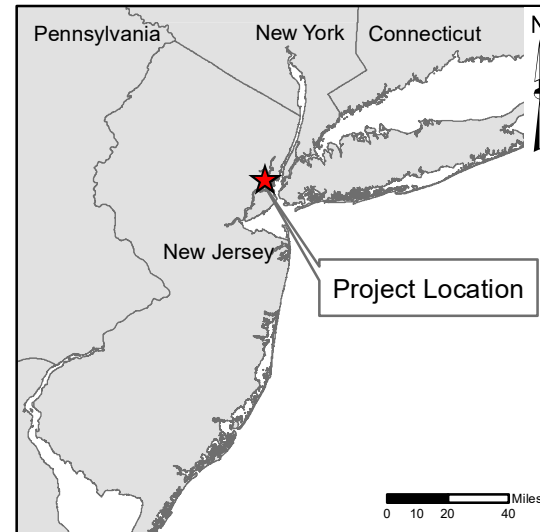

PROJECT SITE MAP

★ Approximate Limits of Newark Bay Bridge



SOURCES:
ESRI, USGS MAP SERVICE. WSP 2022.

NEW JERSEY TURNPIKE AUTHORITY

NEWARK BAY-HUDSON COUNTY EXTENSION PROGRAM
PROJECT 1 - INTERCHANGES 14 TO 14A
NEWARK BAY BRIDGE REPLACEMENT AND ASSOCIATED IMPROVEMENTS
NEWARK BAY MP 3.8
BETWEEN NEWARK, ESSEX COUNTY AND BAYONNE, HUDSON COUNTY
NEW JERSEY

VICINITY MAP

CONSULTANTS:
GANNETT FLEMING, INC.
WSP USA, INC.

DATE: MARCH 4, 2025
SHEET: 1 OF 8

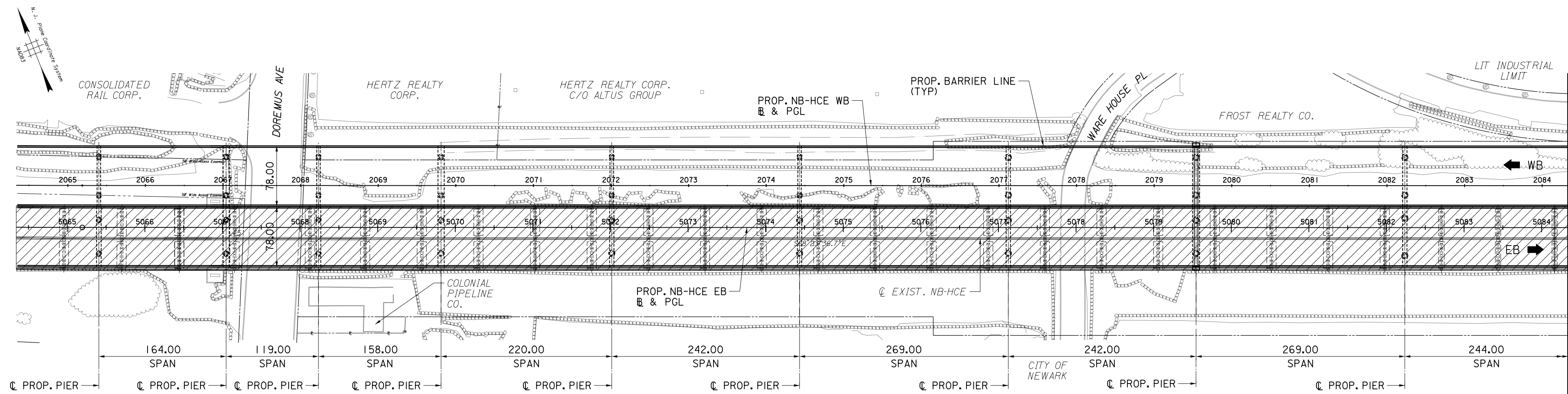

PLAN

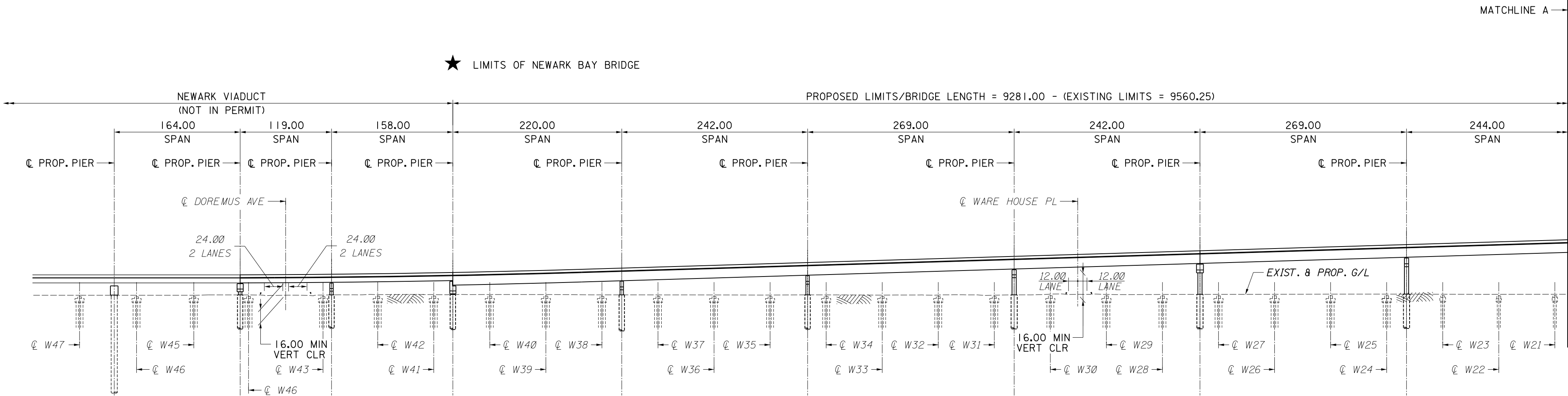

ELEVATION

- NOTES:
- 1. EXISTING BOTTOM OF CHANNEL TAKEN AT THE CENTER LINE OF THE EXISTING BRIDGE BASED ON 2021 BATHYMETRIC SURVEY DATA. ELEVATIONS BASED ON NAVD 88.
 - 2. ALL DIMENSIONS AND DISTANCES ARE IN US LINEAR FEET IN DECIMAL FORMAT.
 - 3. SEE NOTES ON GENERAL PLAN AND ELEVATION - 3.

LEGEND:

EXIST. NB-HCE BRIDGE AREA OF REMOVAL



NOTE:
CONCEPTUAL PLANS UTILIZED TO OBTAIN COAST GUARD BRIDGE PERMIT FOR TWO BRIDGES.

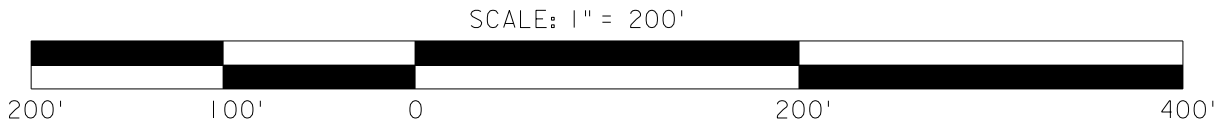

NEW JERSEY TURNPIKE AUTHORITY

NEWARK BAY - HUDSON COUNTY EXTENSION PROGRAM
PROJECT 1 - INTERCHANGES 14 TO 14A
NEWARK BAY BRIDGE REPLACEMENT AND ASSOCIATED IMPROVEMENTS
NEWARK BAY MP 3.8
BETWEEN NEWARK, ESSEX COUNTY AND BAYONNE, HUDSON COUNTY
NEW JERSEY

GENERAL PLAN AND ELEVATION - 1

CONSULTANTS:
GANNETT FLEMING, INC.
WSP USA, INC.

DATE: MARCH 4, 2025
SHEET: 2 OF 8

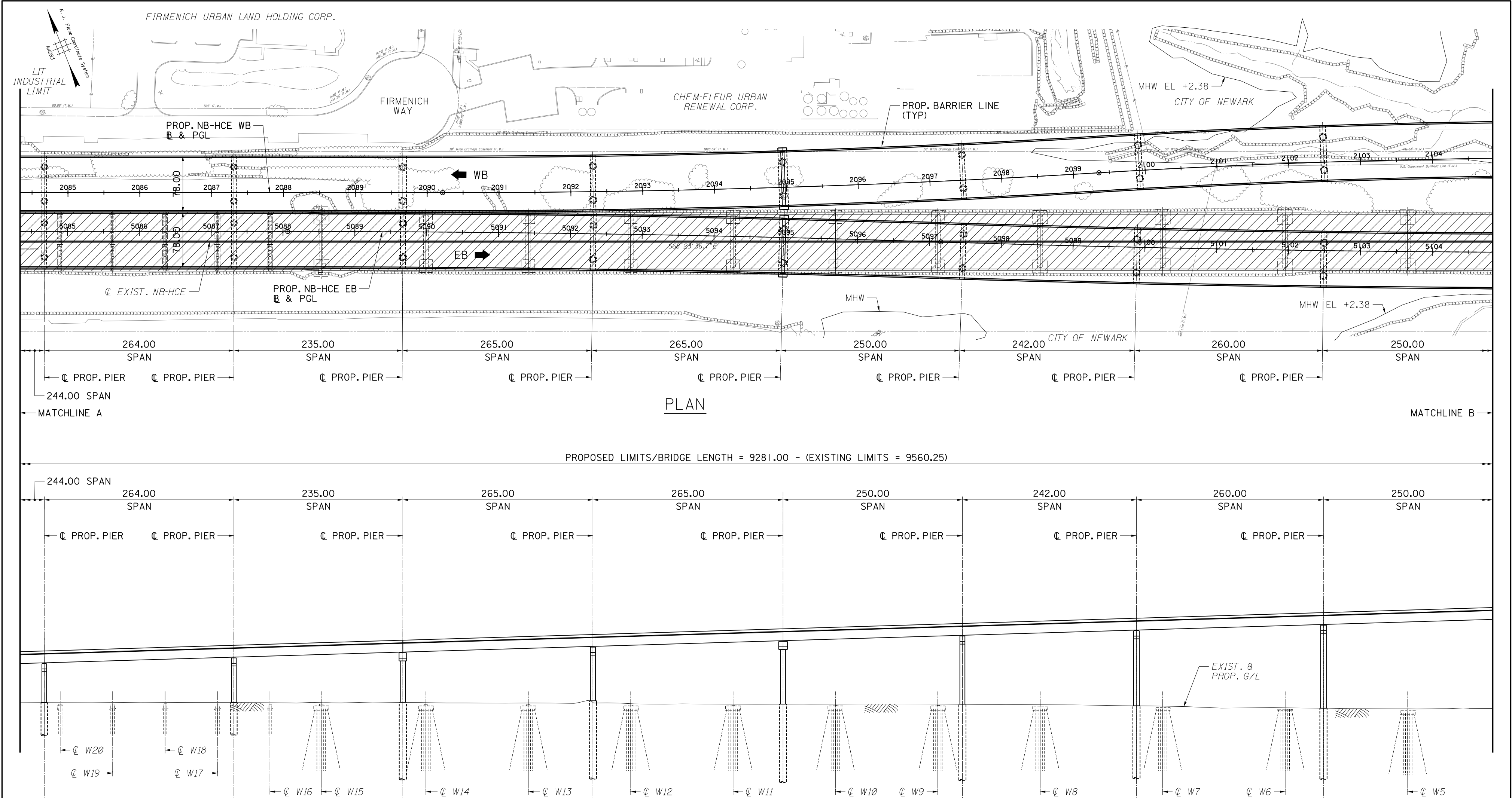

PLAN

ELEVATION

- NOTES:
- EXISTING BOTTOM OF CHANNEL TAKEN AT THE CENTER LINE OF THE EXISTING BRIDGE BASED ON 2021 BATHYMETRIC SURVEY DATA. ELEVATIONS BASED ON NAVD 88.
 - ALL DIMENSIONS AND DISTANCES ARE IN US LINEAR FEET IN DECIMAL FORMAT.
 - SEE NOTES ON GENERAL PLAN AND ELEVATION - 3.

LEGEND:

EXIST. NB-HCE BRIDGE AREA OF REMOVAL

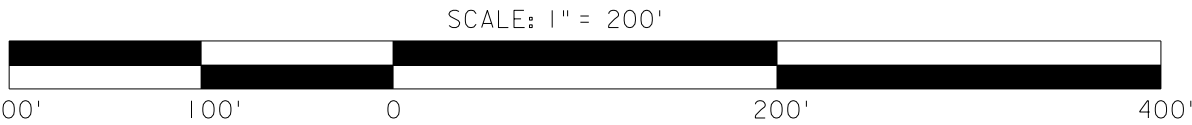

NOTE:
CONCEPTUAL PLANS UTILIZED TO OBTAIN COAST GUARD BRIDGE PERMIT FOR TWO BRIDGES.

NEW JERSEY TURNPIKE AUTHORITY	
NEWARK BAY - HUDSON COUNTY EXTENSION PROGRAM PROJECT 1 - INTERCHANGES 14 TO 14A NEWARK BAY BRIDGE REPLACEMENT AND ASSOCIATED IMPROVEMENTS NEWARK BAY MP 3.8 BETWEEN NEWARK, ESSEX COUNTY AND BAYONNE, HUDSON COUNTY NEW JERSEY	
GENERAL PLAN AND ELEVATION - 2	
CONSULTANTS: GANNETT FLEMING, INC. WSP USA, INC.	DATE: MARCH 4, 2025 SHEET: 3 OF 8

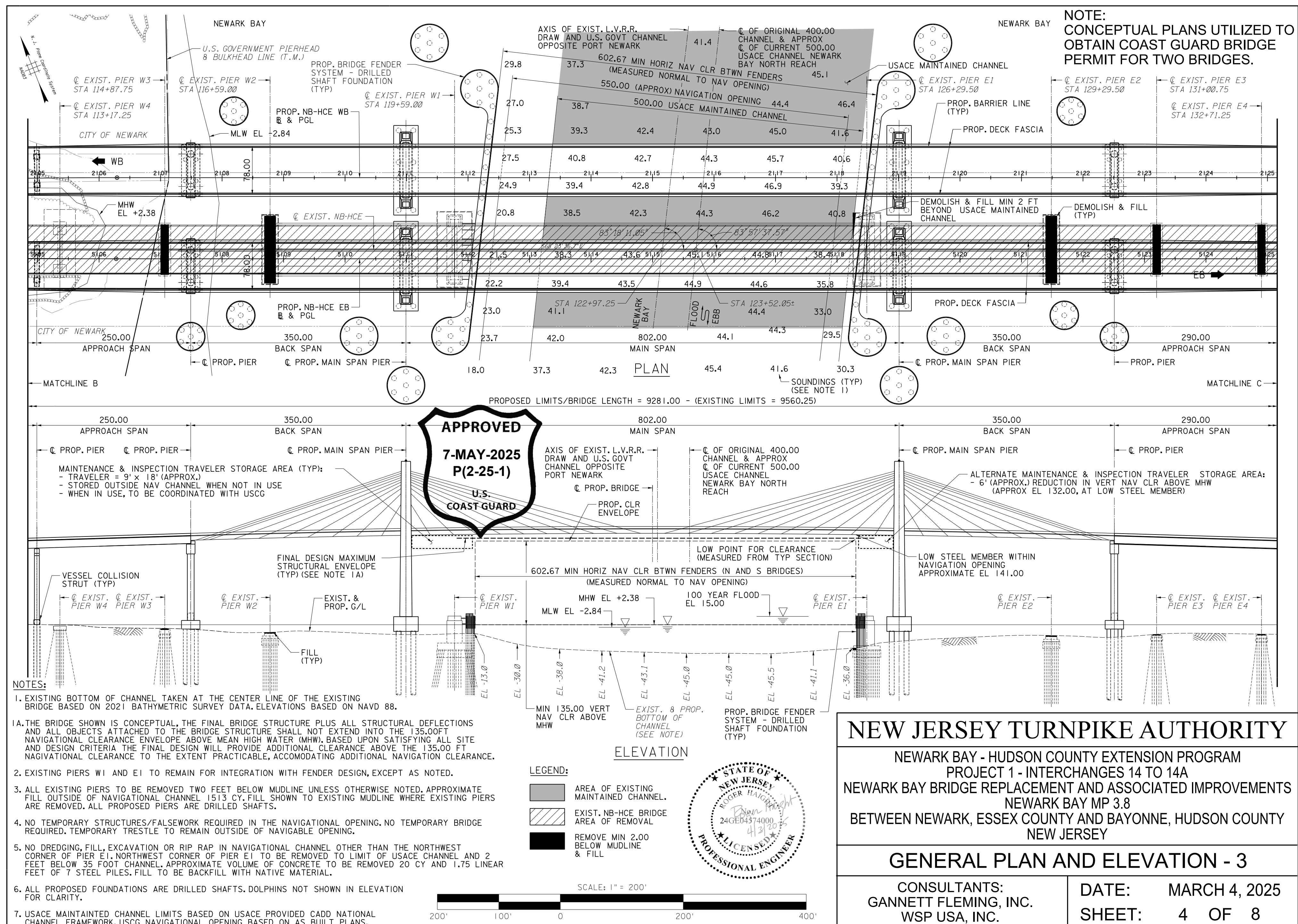

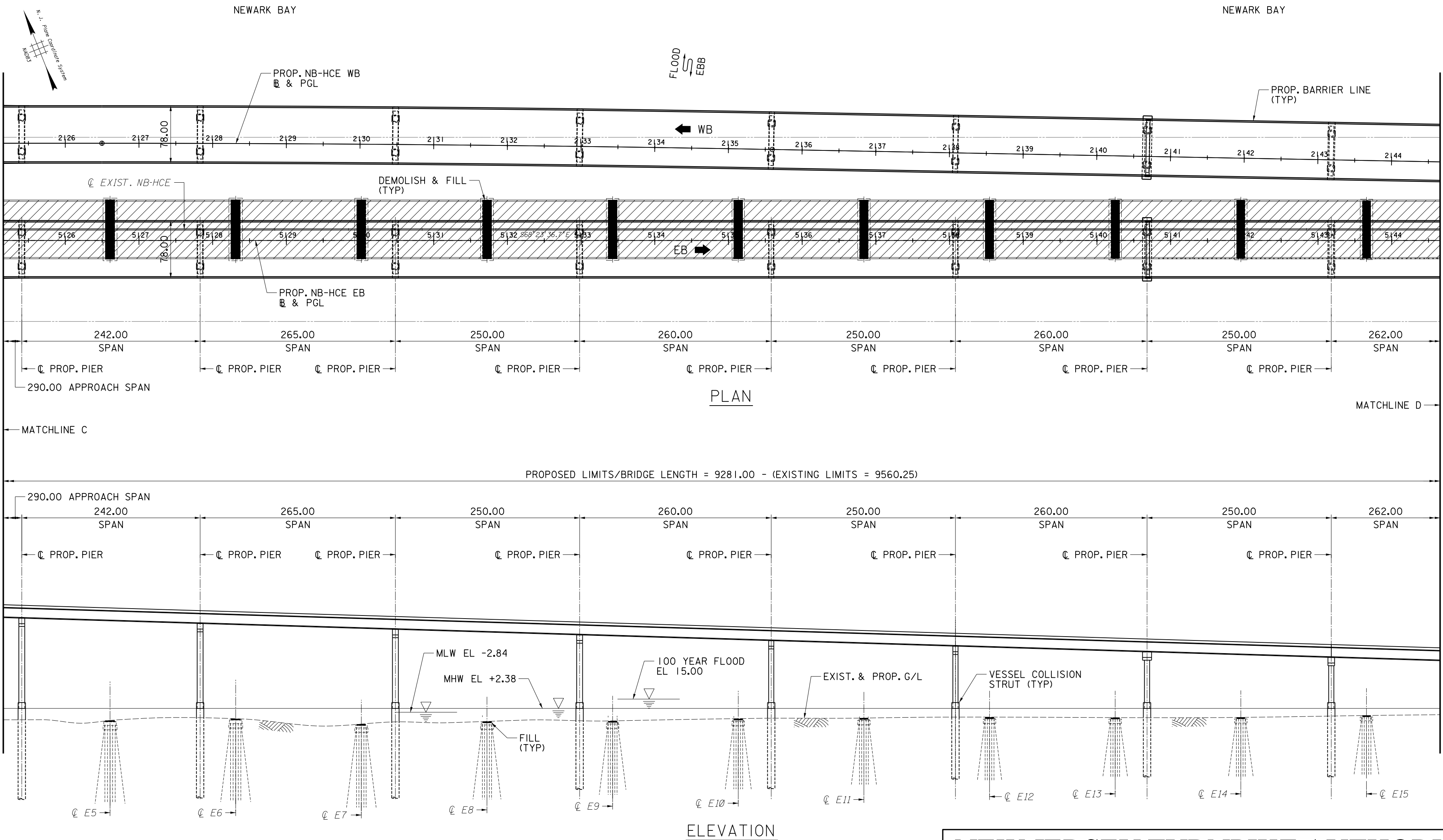

NOTES:

1. EXISTING BOTTOM OF CHANNEL TAKEN AT THE CENTER LINE OF THE EXISTING BRIDGE BASED ON 2021 BATHYMETRIC SURVEY DATA. ELEVATIONS BASED ON NAVD 88.
2. ALL DIMENSIONS AND DISTANCES ARE IN US LINEAR FEET IN DECIMAL FORMAT.
3. SEE NOTES ON GENERAL PLAN AND ELEVATION - 3.

LEGEND:

- EXIST. NB-HCE BRIDGE AREA OF REMOVAL
- REMOVE MIN 2.00 BELOW MUDLINE & FILL



NOTE:
CONCEPTUAL PLANS UTILIZED TO OBTAIN COAST GUARD BRIDGE PERMIT FOR TWO BRIDGES.

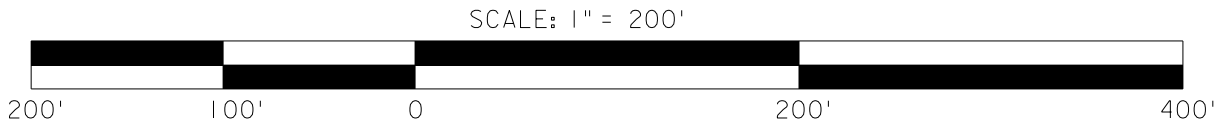

NEW JERSEY TURNPIKE AUTHORITY

NEWARK BAY - HUDSON COUNTY EXTENSION PROGRAM
PROJECT 1 - INTERCHANGES 14 TO 14A
NEWARK BAY BRIDGE REPLACEMENT AND ASSOCIATED IMPROVEMENTS
NEWARK BAY MP 3.8
BETWEEN NEWARK, ESSEX COUNTY AND BAYONNE, HUDSON COUNTY
NEW JERSEY

GENERAL PLAN AND ELEVATION - 4

CONSULTANTS:
GANNETT FLEMING, INC.
WSP USA, INC.

DATE: MARCH 4, 2025
SHEET: 5 OF 8



LIMITS OF NEWARK BAY BRIDGE ★

PROPOSED LIMITS/BRIDGE LENGTH = 9281.00 - (EXISTING LIMITS = 9560.25)



NEWARK BAY - HUDSON COUNTY EXTENSION PROGRAM
PROJECT 1 - INTERCHANGES 14 TO 14A
NEWARK BAY BRIDGE REPLACEMENT AND ASSOCIATED IMPROVEMENTS
NEWARK BAY MP 3.8
BETWEEN NEWARK, ESSEX COUNTY AND BAYONNE, HUDSON COUNTY
NEW JERSEY



CONSULTANTS:
GANNETT FLEMING, INC.
WSP USA, INC.

DATE: MARCH 4, 2025
SHEET: 6 OF 8

NOTES:

1. EXISTING BOTTOM OF CHANNEL TAKEN AT THE CENTER LINE OF THE EXISTING BRIDGE BASED ON 2021 BATHYMETRIC SURVEY DATA. ELEVATIONS BASED ON NAVD 88.
2. ALL DIMENSIONS AND DISTANCES ARE IN US LINEAR FEET IN DECIMAL FORMAT.
3. SEE NOTES ON GENERAL PLAN AND ELEVATION - 3.

LEGEND:

-  EXIST. NB-HCE BRIDGE
 AREA OF REMOVAL
 REMOVE MIN 2.00 BELOW
 MUDLINE & FILL



SCALE: 1" = 200'

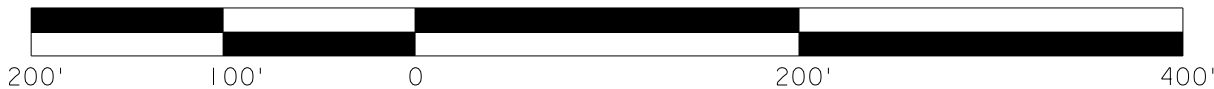

NOTE:
CONCEPTUAL PLANS UTILIZED TO OBTAIN COAST
GUARD BRIDGE PERMIT FOR TWO BRIDGES.

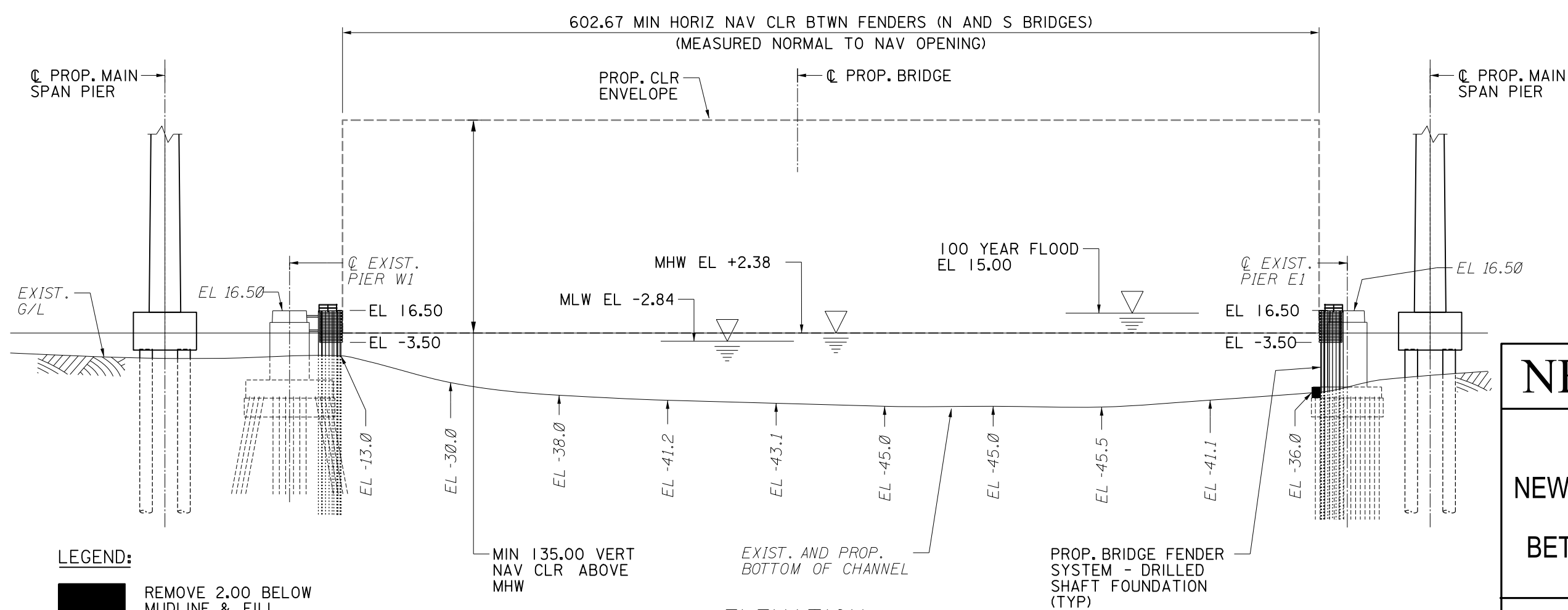
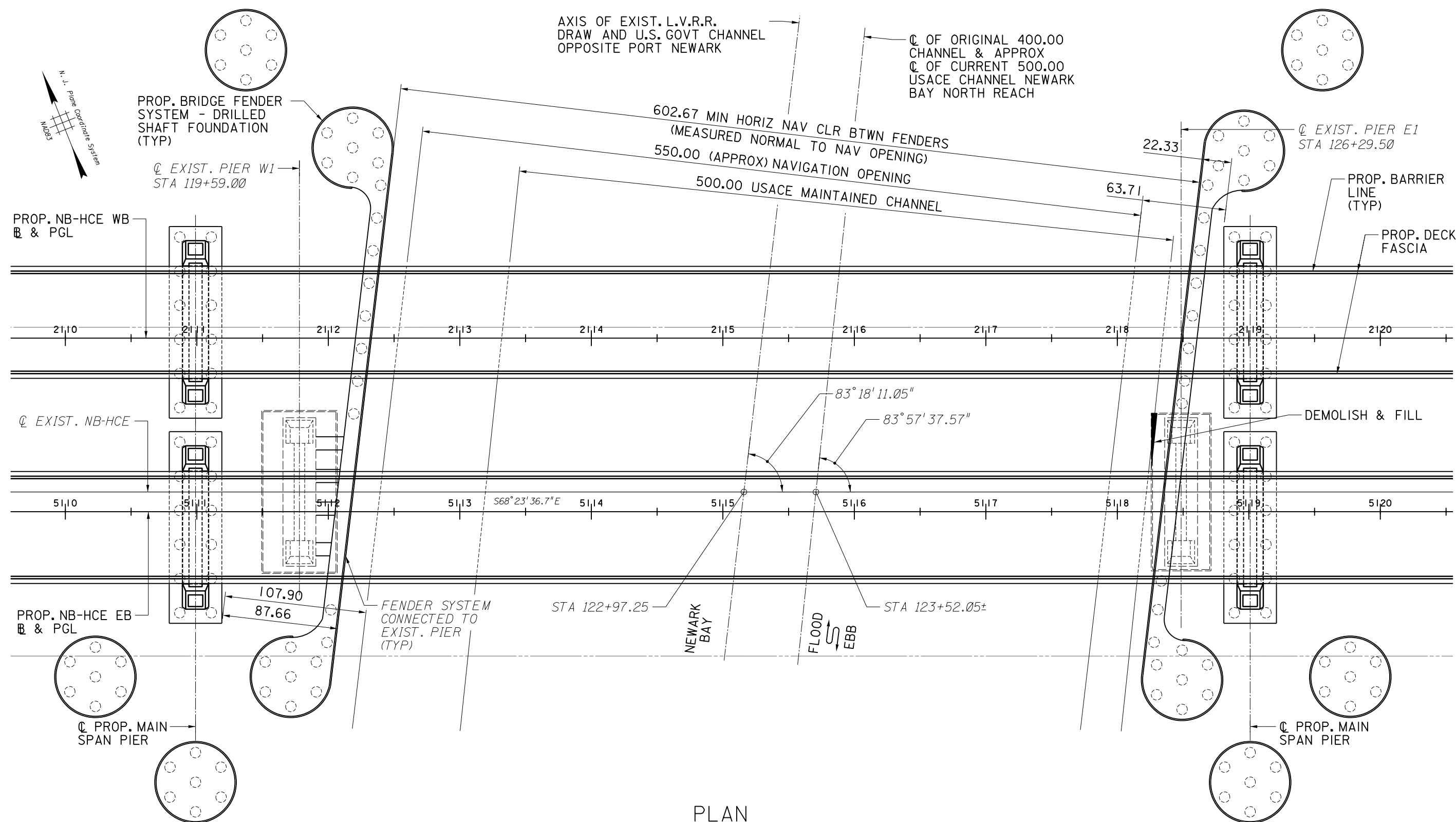

NOTES:

1. PROPOSED FENDERS TO USE EXISTING MAIN PIER FOUNDATIONS FOR SUPPORT AND ENERGY DISSIPATION. NO PROPOSED FENDERS TO BE ATTACHED TO PROPOSED STRUCTURES.
2. COUNTERSUNK BOLTS TO BE UTILIZED FOR ALL NAVIGATION FACING CONNECTIONS.
3. FENDERS DESIGN AND DETAILING TO MEET ALL APPLICABLE AASHTO STANDARDS AND COORDINATE WITH PROJECT STAGING.
4. DOLPHINS NOT SHOWN IN ELEVATION FOR CLARITY.
5. USACE MAINTAINED CHANNEL BASED ON USACE PROVIDED CADD LINEWORK. USCG NAVIGATIONAL OPENING BASED ON AS BUILT PLANS.
6. SEE ADDITIONAL NOTES ON "GENERAL PLAN AND ELEVATION - 3".



NEW JERSEY TURNPIKE AUTHORITY

NEWARK BAY - HUDSON COUNTY EXTENSION PROGRAM
PROJECT 1 - INTERCHANGES 14 TO 14A
NEWARK BAY BRIDGE REPLACEMENT AND ASSOCIATED IMPROVEMENTS
NEWARK BAY MP 3.8
BETWEEN NEWARK, ESSEX COUNTY AND BAYONNE, HUDSON COUNTY
NEW JERSEY

BRIDGE PROTECTION SYSTEM DETAILS

CONSULTANTS:
GANNETT FLEMING, INC.
WSP USA, INC.

DATE:	MARCH 4, 2025
SHEET:	7 OF 8

NOTE:
CONCEPTUAL PLANS UTILIZED TO OBTAIN COAST
GUARD BRIDGE PERMIT FOR TWO BRIDGES.

