

## U.S.C.G. Merchant Marine Exam

### Mobile Offshore Drilling Units

### Q437 Barge Supervisor – Deck General – Safety

### (Sample Examination)

**Choose the best answer to the following Multiple-Choice Questions.**

1. Which term is given to a tornado that moves out over the water from land?

- A. A tornado
- B. A hurricane
- C. A waterspout
- D. A cyclone

Correct answer: C

2. How can you estimate the position of a tropical storm's center?

- A. Using shipboard radar
- B. With a radio weather bulletin or weather fax
- C. Observe the wind direction and apply Buys Ballot's law
- D. All of the above

Correct answer: D

3. Which term is given to the mechanical lifting of air by the upslope slant of the terrain?

- A. Advective lifting
- B. Vertical lifting
- C. Convective lifting
- D. Topographic lifting

Correct answer: D

4. If the current and wind are in the same direction, what does the sea surface represent concern the true wind speed?

- A. The appearance of the sea surface does not change
- B. It appears less than actually exists
- C. It appears higher than actually exists
- D. It appears at the correct speed

Correct answer: B

5. Which of the listed properties does warm air possess?

- A. Atmospheric pressure rises as warm air rises
- B. It rises above cooler air and cools as it rises
- C. Moisture in warm air condenses as the air is heated
- D. Warm air that has cooled will develop low pressure areas

Correct answer: B

6. Temperature and moisture characteristics are modified in a warm or cold air mass due to which factor?
- A. Upper-level atmospheric changes
  - B. Movement of the air mass
  - C. Pressure changes in the air mass
  - D. The heterogeneous nature of the air mass

Correct answer: B

7. Which time meridian is used for tide computations in New York Harbor?
- A. 82°30'W
  - B. 60°00'W
  - C. 52°30'W
  - D. 75°00'W

Correct answer: D

8. The datum from which the predicted heights of tides are reckoned in the tide tables is the same as that used for the charts of the locality. The depression of the datum below mean sea level for Hampton Roads, Virginia is \_\_\_\_\_.
- A. 1.2 feet
  - B. between -.7 and +.5 feet
  - C. 4.1 feet
  - D. between 1.9 and 3.2 feet

Correct answer: A

9. Which is TRUE if passengers are on board when an abandon ship drill is carried out?
- A. The passengers should take part in the drill
  - B. The passengers should just watch
  - C. The passengers should stay out of the way and do what they want
  - D. Passengers should go to their quarters during drills

Correct answer: A

10. Lifesaving regulations in Subchapter W require that a fire drill include which of the following?
- A. Checking arrangements for abandon ship
  - B. Starting the fire pumps
  - C. Checking the operation of watertight doors
  - D. All of the above

Correct answer: D

11. You are on the second deck of the engine room between frames 92 thru 105 and the space is filling up with smoke. Utilizing illustration D037SA below, where is the primary means of escape from that area via a ladderwell?

- A. portside ladderwell, frame 106
- B. portside ladderwell, frame 93
- C. starboard side ladderwell, frame 119
- D. Either A or B

Correct answer: A

12. Which is TRUE of paints and solvents on a vessel?

- A. They must be covered at all times to protect from ignition sources
- B. They should be stored safely at the work site until work is completed
- C. They should be returned to the paint locker after each use
- D. They must be stored in a gear locker

Correct answer: C

13. Which is one of the limitations of foam as an extinguishing agent?

- A. Foam is corrosive to all steel surfaces and is hazardous to firefighters
- B. Foam cannot be made with salt water
- C. Foam conducts electricity
- D. Foam is heavier than oil and sinks below its surface

Correct answer: C

14. Foam extinguishes a fire mainly by \_\_\_\_\_.

- A. inerting the air
- B. cooling
- C. smothering
- D. chemical action

Correct answer: C

15. The carbon dioxide cylinders of a fixed fire extinguishing system may be located inside the protected space, if the quantity of CO<sub>2</sub> required to protect that space is not more than which amount?

- A. 300 pounds
- B. 400 pounds
- C. 500 pounds
- D. 600 pounds

Correct answer: A

16. Which statement(s) is(are) TRUE concerning the use of dry chemical extinguishers?

- A. You should direct the spray directly into the fire.
- B. You should direct the spray at a vertical bulkhead and allow it to flow over the fire.
- C. You should direct the spray at the base of the fire.
- D. On a weather deck approach the fire from the leeward side.

Correct answer: C

17. Which is an advantage of a dry chemical over a carbon dioxide fire extinguisher?

- A. Cleanliness
- B. Greater discharge range
- C. Noncorrosive
- D. All of the above

Correct answer: B

18. Which is the primary method by which water spray puts out fires?

- A. By removing the oxygen
- B. By removing combustible material
- C. Cooling the fire below the ignition temperature
- D. Diluting combustible vapors

Correct answer: C

19. Which is the most effective cooling agent among those normally used to fight fires?

- A. Chemical foam
- B. Water fog or spray
- C. Carbon dioxide
- D. Mechanical foam

Correct answer: B

20. Which statement describes the primary process by which fires are extinguished by dry chemical?

- A. The powder forms a solid coating over the surface.
- B. The stream of dry chemical powder cools the fire.
- C. The dry chemical powder attacks the fuel and oxygen chain reaction.
- D. The dry chemical smothers the fire.

Correct answer: C

21. In a wire rope mooring system, the fairlead sheave should be a minimum of \_\_\_\_\_.

- A. 10-18 times the diameter of the wire rope
- B. 18-36 times the diameter of the wire rope
- C. 36-50 times the diameter of the wire rope
- D. 50-75 times the diameter of the wire rope

Correct answer: B

22. The chemicals in sacks aboard MODU's are palletized to reduce \_\_\_\_\_.

- A. contamination
- B. pilferage
- C. marking and labeling
- D. labor in loading and handling

Correct answer: D

23. The major cause of anchor buoy pendant wire failures is \_\_\_\_\_.

- A. defective sockets
- B. rough weather
- C. corrosion
- D. mishandling

Correct answer: B

24. A helicopter making a round trip from a helodeck with refueling capabilities to an unmanned platform will take 45 minutes each way. The helicopter should be carrying enough fuel to last \_\_\_\_\_.

- A. 45 minutes
- B. 1 hour and 15 minutes
- C. 1 hour and 30 minutes
- D. 2 hours

Correct answer: D

25. Where there are multiple accident victims, which type of injury should be the first to receive emergency treatment?

- A. Burns
- B. Major multiple fractures
- C. Eye injuries
- D. Severe shock

Correct answer: D

26. What are the symptoms of seasickness?

- A. Nausea and dizziness
- B. Stomach cramps and diarrhea
- C. Fever and thirst
- D. Reddening of skin and hives

Correct answer: A

27. As a last resort, what can a tourniquet be used for?

- A. To restrain a delirious victim
- B. To stop uncontrolled bleeding
- C. To hold a victim in a stretcher
- D. To hold a large bandage in place

Correct answer: B

28. Ordinarily, bleeding from a vein may be controlled by what method?

- A. Applying direct pressure to the wound
- B. Pouring ice water directly onto the wound
- C. Heavy application of a disinfectant
- D. Pinching the wound closed

Correct answer: A

29. The helicopter deck on an offshore drilling unit is required to be fitted with perimeter lights in alternating colors of \_\_\_\_\_.

- A. red and white
- B. yellow and blue
- C. yellow and white
- D. yellow and red

Correct answer: B

30. The discharge side of every fire pump must be equipped with a \_\_\_\_\_.

- A. strainer
- B. pressure gauge
- C. gate valve
- D. check valve

Correct answer: B

31. The person in charge of a mobile offshore drilling unit must insure that \_\_\_\_\_.

- A. the date and hour of each fire drill is recorded in the log
- B. each bilge pump is operated at least once a week
- C. whistles and general alarm bells are tested once each day
- D. all personnel are provided with work vests

Correct answer: A

32. To determine the number of portable fire extinguishers required on a mobile offshore drilling unit, you should check the \_\_\_\_\_.

- A. Certificate of Inspection
- B. hot work permit
- C. Operations Manual
- D. Safety of Life at Sea Certificate

Correct answer: A

33. To determine the number of industrial personnel allowed on a mobile offshore drilling unit, you should check the \_\_\_\_\_.

- A. Certificate of Inspection
- B. Operations Manual
- C. Muster List ("Station Bill")
- D. Safety of Life at Sea Certificate

Correct answer: A

34. A MODU crane which has been idle for a period of over six months shall be inspected to the same standards as a \_\_\_\_\_.
- A. yearly inspection
  - B. quarterly inspection
  - C. monthly inspection
  - D. weekly inspection

Correct answer: A

35. Where would you find the "call sign" or "call letters" of the radio station on your rig?
- A. On the rig Watch Bill
  - B. On the Certificate of Inspection
  - C. On the Ship Station License
  - D. In the rig safety manual

Correct answer: C

36. You are standing a radio watch aboard the rig. A crew boat calls you on VHF channel 16. When you reply with your vessel name and call letters, you should request the crew boat to switch to which of the following channels?
- A. 6
  - B. 10
  - C. 12
  - D. 14

Correct answer: B

37. Offshore drilling units must have at least two ring buoys with water lights that, when released from the mounting rack, activate a \_\_\_\_\_.
- A. smoke signal
  - B. radio signal
  - C. battery powered horn
  - D. steam whistle

Correct answer: A

38. Where would you find the FCC authorization for transmitting on your rig's EPIRB?
- A. On the side of the EPIRB transmitter
  - B. In the radio log
  - C. On the Certificate of Inspection
  - D. On the Ship Station License

Correct answer: D



39. The Master or person in charge on a MODU shall insure that line throwing equipment is not operated \_\_\_\_\_.

- A. during a rain storm
- B. by other than senior rig personnel
- C. in an explosive atmosphere
- D. near a lifeboat station

Correct answer: C

40. The signal to man emergency stations on MODU's is \_\_\_\_\_.

- A. a rapid succession of short soundings of the general alarm and whistle
- B. 30 seconds on/30 seconds off alternating signal
- C. announced over PA system
- D. continuous ringing of general alarm signal

Correct answer: A

41. A jack-up drilling rig being towed must \_\_\_\_\_.

- A. turn off all lights that interfere with the navigation lights
- B. ring the bell rapidly for five seconds once a minute
- C. display two black diamonds in a vertical line during the day
- D. turn on all available working lights on deck

Correct answer: A

42. The instructions for launching lifeboats and liferafts on a MODU are a requirement of the \_\_\_\_\_.

- A. Coast Guard
- B. person-in-charge of the unit
- C. lease operator
- D. Minerals Management Service

Correct answer: A

43. Each buoyant work vest on a MODU must be \_\_\_\_\_.

- A. equipped with a water light
- B. marked with the name of the unit
- C. Coast Guard approved
- D. All of the above

Correct answer: C

44. The Muster List ("Station Bill") shows each person's lifeboat station, duties during abandonment, basic instructions, and \_\_\_\_\_.

- A. instructions for lowering the lifeboats
- B. work schedule
- C. all emergency signals
- D. the time each weekly drill will be held

Correct answer: C

45. The person assigned to command a lifeboat or inflatable liferaft on a MODU shall have a list of the persons assigned to the lifeboat or liferaft. The list shall include each person's \_\_\_\_\_.
- A. home address
  - B. home phone number
  - C. nearest relative's address
  - D. duties

Correct answer: D

46. On offshore drilling units, the lifeboat motors shall be operated in the ahead and astern position at least once each \_\_\_\_\_.
- A. day
  - B. week
  - C. month
  - D. year

Correct answer: B

47. Which statement is TRUE concerning life preservers (Type I personal flotation devices)?
- A. Life preservers must always be worn with the same side facing outwards to float properly.
  - B. Lightly stained or faded life jackets will fail in the water and should not be used.
  - C. Buoyant vests may be substituted for life jackets.
  - D. Life preservers are designed to turn an unconscious person's face clear of the water.

Correct answer: D

48. When should the external inflation bladder on an immersion suit be inflated?
- A. After you notice that your suit is losing buoyancy
  - B. Before you enter the water
  - C. After one hour in the water
  - D. After you enter the water

Correct answer: D

49. What statement about immersion suits is TRUE?
- A. Any tear or leak will render the suit unserviceable, and it must be replaced.
  - B. During the annual maintenance, the front zipper should be lubricated using light machine oil or mineral oil.
  - C. Immersion suits should be worn while performing routine work on deck.
  - D. No stowage container for immersion suits may be capable of being locked.

Correct answer: D

50. Which statement is TRUE concerning life jackets?
- A. Buoyant vests may be substituted for life jackets.
  - B. Life jackets must always be worn with the same side facing outwards to float properly.
  - C. Lightly stained or faded life jackets will fail in the water and should not be used.
  - D. Life jackets are designed to turn an unconscious person's face clear of the water.

Correct answer: D

**D037SA**

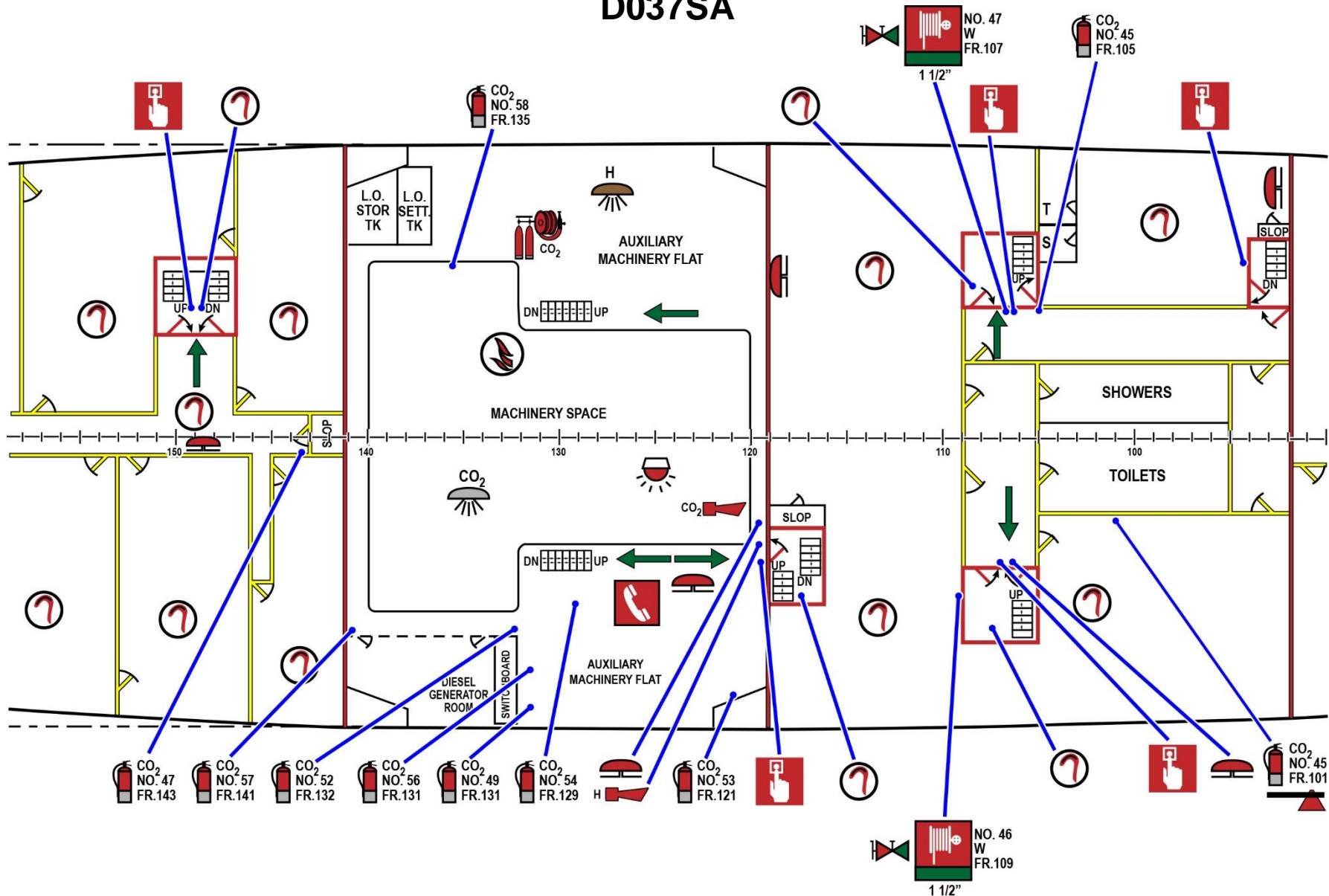

Adapted for testing purposes only from Graphical Symbols for Shipboard Fire Control Plans  
IMO Resolution A.952(23) Adopted 2003  
Further reproduction prohibited without permission